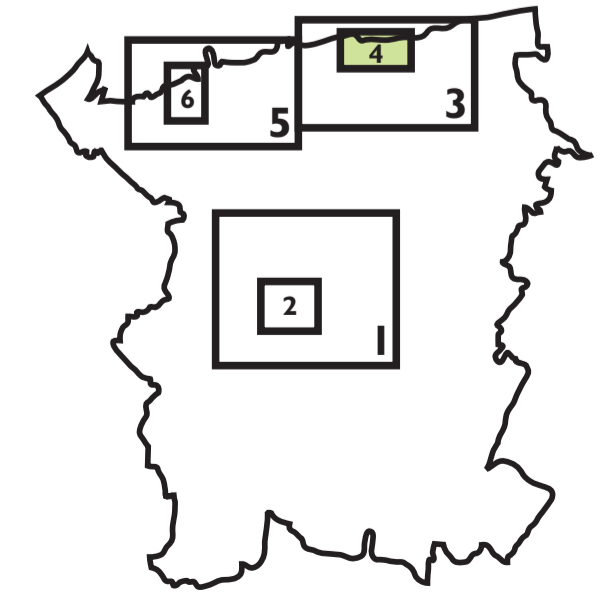

This map is reproduced from the Ordnance Survey material with the permission of Ordnance Survey on behalf of the Controller of Her Majesty's Stationery Office © Crown Copyright. Unauthorised reproduction infringes Crown copyright and may lead to prosecution or civil proceedings. Canterbury City Council. 100019614. 2014. Additional overlaid information is copyright of Canterbury City Council. Produced by the Cook Hammond & Kell Group.

CANTERBURY DISTRICT LOCAL PLAN

Publication Draft
June 2014

Inset 4: Herne Bay Town Centre
Shown overleaf: Inset 5 Whitstable

- BOUNDARIES**
 - Boundary of Inset
 - Boundary of Urban Area
- HOUSING DEVELOPMENT**
 - Housing HD1
- ECONOMIC DEVELOPMENT AND EMPLOYMENT**
 - Employment EMP1
 - Protection of Employment Sites EMP4
- TOWN CENTRES AND LEISURE**
 - Herne Bay Town Centre TCL1
 - Primary Shopping Frontage TCL2

- Mixed Shopping Frontage TCL3
- Local Centre TCL5
- Leisure TCL11
- TRANSPORT INFRASTRUCTURE**
 - Cycle & Pedestrian Route T2
- CLIMATE CHANGE**
 - Environment Agency Area at Risk of Flooding Zone 2 CC5, CC6
 - Environment Agency Area at Risk of Flooding Zone 3 CC5, CC6

- HISTORIC ENVIRONMENT**
 - Conservation Area HE6
- LANDSCAPE AND BIODIVERSITY**
 - Undeveloped Coast LB3
 - International Wildlife Sites (Special Protection Area, RAMSAR, Special Area for Conservation) LBS
 - Site of Special Scientific Interest LB6
- OPEN SPACE**
 - Protection of Existing Open Space OS9

The numbers refer to policies in the Written Statement. In addition, the following policies are relevant to the area covered by the Inset:

SP1, SP2, SP4-SP7, HD2, HD8, HD9, EMP2-EMP6, EMP9, TCL6, TCL8, TCL9, TCL11, TCL12, T1, T3, T4, T9, T10, T17, TV1-TV3, TV5, CC1, CC2, CC3, CC4, CC11-CC13, DBE1-DBE13, HE1, HE4, HE5, HE7-HE13, LB8-LB10, LB13, OS2, OS8-OS12, OS14, OS15, QL1, QL5, QL6, QL8, QL10-QL13.

- AREA ACTION PLAN POLICIES, ADOPTED 2010**
 - Action Area Plan Boundary
 - Central Development Area HB1
 - Beach Street HB2
 - Bus Depot HB3
 - Herne Bay Pier HB11
 - Memorial Park Improvements HB12
 - Seafront Commercial Core HB14
- Other AAP policies that apply to this Inset: HB4 - HB10, HB13, HB15 - HB21

