

GENERAL DRAINAGE NOTES

- UNLESS OTHERWISE SHOWN ALL PIPEWORK SHALL BE 150mm INTERNAL DIAMETERS AND LAID TO A GRADIENT NOT FLATTER THAN 1:100 FOR SURFACE WATER AND 1:400 FOR FOUL WATER (OR MIN. 1:800 WHERE MIN. OF 1 WC IS CONNECTED)
- PIPEWORK OTHER THAN THAT COVERED IN NOTE 1 ABOVE SHALL BE IDENTIFIED THUS:
 - DIA. 150 GRADIENT 1 IN 150
 - SHOWS AN APPROXIMATE GRADIENT eg. 1in125
 - SHOWS INTERNAL DIAMETER OF PIPE IN mm.
- AT MANHOLES AND INSPECTION CHAMBERS:
 - CL.12.345 = APPROXIMATE COVER LEVEL
 - 80.10.95 = BACKDROP INVERT LEVEL
 - IL.5.8.76 = INVERT LEVEL

FOUL WATER	SURFACE WATER
<ul style="list-style-type: none"> FOUL WATER DRAIN/SEWER ADOPTABLE FOUL WATER MANHOLE FOUL WATER RISING MAIN PRIVATE MANHOLE SHALLOW INSPECTION CHAMBER (MINIMUM 300mm) MEDIUM/DEEP INSPECTION CHAMBER (MINIMUM 450mm) BACKDROP TRAPPED YARD GULLY WASTE CONNECTION - REFER TO ARCHITECTURAL DRAWINGS FOR CONNECTION TYPE AND SETTING OUT VENTILATION AT THE HEAD OF FOUL MAIN - REFER TO ARCHITECTURAL DRAWINGS FOR FURTHER VENTILATION REQUIREMENTS 	<ul style="list-style-type: none"> SURFACE WATER DRAIN/SEWER REFOURATED DRAIN/SEWER (ADOPTABLE IF AS SHOWN ON CONNECTIONS) ADOPTABLE SURFACE WATER MANHOLE SHALLOW INSPECTION CHAMBER (MINIMUM 300mm) MEDIUM/DEEP INSPECTION CHAMBER (MINIMUM 450mm) ALL SW CHAMBERS PRIOR TO CONNECTION TO DIFFUSER OF INFRASTRUCTURE NETWORK TO BE CATCHPIT TYPE BACKDROP RODDING EYE ROAD GULLY (150mm PIPEWORK) YARD GULLY CHANNEL DRAIN SUCH AS ACCO OR SIMILAR, WHERE LOCATED AT THRESHOLD DRAIN AS ACCO DOORWAY DRAIN ACC SWALE INLET (OR SIMILAR APPROVED DISTRIBUTION UNIT AS SEL ENVIRONMENTAL WAD05/01 LOOPING PIPEWORK) DESIGNATES EXTENT OF DRIVEWAYS FORMED WITH PERMEABLE PAVING DESIGNATES DRY SERVICE MARGIN WITHIN EXTENT OF PERMEABLE PAVING

WATER PRESSURE GAS MAIN

ALL DRAINAGE CHAMBER COVERS ARE TO BE LOCATED FULLY IN SOFT OR HARD LANDSCAPING, COVERS SHALL NOT BE POSITIONED HALF IN / HALF OUT OF DIFFERING SURFACE TREATMENTS

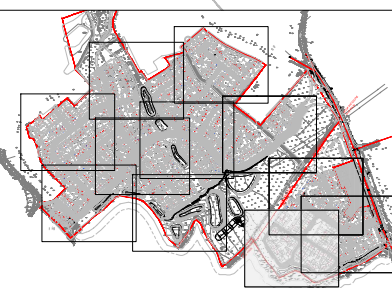

SHEET LAYOUT
SCALE: 1:5000

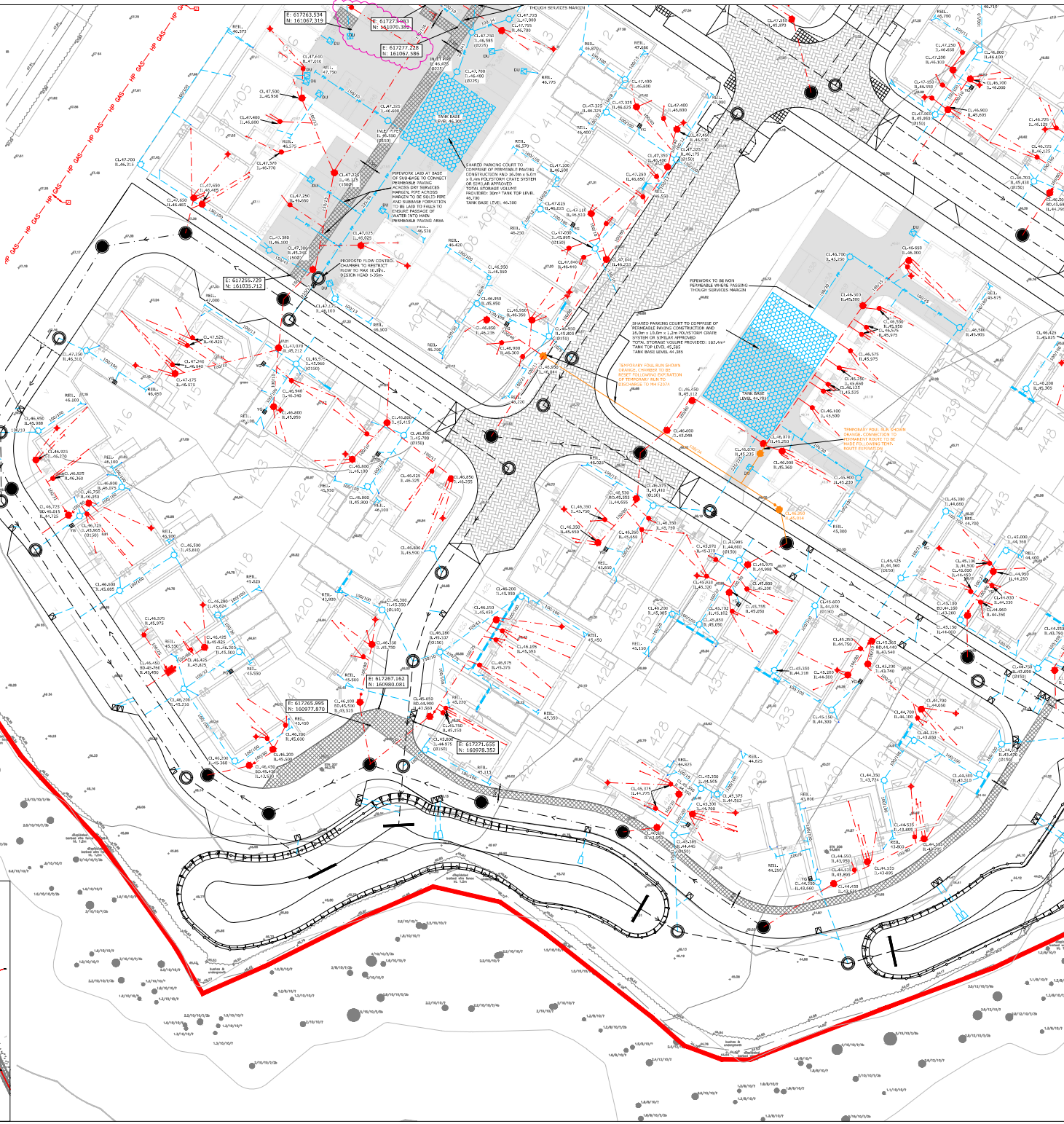

PRIVATE DRAINAGE NOTES

- THIS DRAWING IS TO BE READ IN CONJUNCTION WITH ALL RELATED RICHARD JACKSON LTD. ARCHITECTS AND SUB-CONTRACTOR DRAWINGS. IN CASE OF DISCREPANCIES BETWEEN DRAWINGS REFER TO SITE FOR CLARIFICATION.
- ALL HIGHWAY WORKS ARE TO BE CARRIED OUT TO THE REQUIREMENTS AND SPECIFICATION OF KENT COUNTY COUNCIL HIGHWAYS AUTHORITY.
- TERRACONICAL SURVEY UNDERTAKEN BY J.C. WHITE GEOMETRICS LTD, DRAWING REFERENCE EY05085 DATED 14/04/2021.
- BASED UPON ARCHITECTURAL LAYOUT UNDERTAKEN BY THE NOBLE CONSULTANCY LTD DRAWING REFERENCE 1101-4.
- ALL DIMENSIONS ARE IN METRES UNLESS NOTED OTHERWISE.
- ALL STATUTORY SERVICE SUPPLIERS PLANT IS TO BE LOCATED AND PROTECTED BY THE CONTRACTOR PRIOR TO COMMENCEMENT.
- ANY UNIDENTIFIED HAZARDS DISCOVERED DURING THE PROGRESS OF WORKS ARE TO BE REPORTED IMMEDIATELY TO THE ENGINEER.
- WHERE DRAINAGE PASSES BENEATH BUILDINGS, PIPES TO HAVE A MINIMUM OF 150mm GRANULAR SURROUND OR OTHER FLEXIBLE FILLING.
- BACKFILL TO TRENCHES MAY BE SUITABLE EXCAVATED MATERIAL IN LANDSCAPED AREAS. TYPE 1 GRANULAR MATERIAL TO BE USED UNDER HARD STANDING AND ROADS.
- MANHOLE COVERS WITHIN BLOCK PAVED AREAS SHALL BE RECESSED.
- VENTILATION SHALL BE PROVIDED AT THE HEAD OF FOUL DRAINAGE RUNS, FOR SETTING OUT OF SOIL AND RAINWATER DRAINAGES REFER TO ARCHITECTS DRAWINGS.
- ALL EXTERNAL AREAS WITH MACADAM SURFACES ARE TO BE DRAINED BY TRAPPED GULLIES OR ACC DRAINAGE CHANNELS.
- ACCESS FOR RODCONNECTION SHALL BE PROVIDED TO ALL SOIL AND RAINWATER DRAINAGES ABOVE FINISHED FLOOR LEVEL.
- THE CONTRACTOR IS TO PROTECT EXISTING BURIED PIPES (PARTICULARLY SHALLOW PIPES) AND TREE ROOTS FROM DAMAGE CAUSED BY LOADS AND CONSTRUCTION PLANT.
- MANHOLE COVER LEVELS SHOWN ON THE DRAWING ARE APPROXIMATE. EXACT LEVEL TO BE DETERMINED ON SITE TO SUIT ADJACENT FINISHED GROUND LEVELS.
- ALL RAINWATER PIPES ADJACENT TO THE ANCIENT WOODLAND TO BE FITTED WITH LEAK GUARDS AT LEVELS.
- WHERE PIPES CROSS WITH LESS THAN 300mm BETWEEN SOFFIT AND INVERT, PIPES SHALL BE SURROUNDED IN 150mm THICK GEN3 CONCRETE.
- THE CONTRACTOR IS RESPONSIBLE FOR CHECKING AND VERIFYING THE EXISTING GUTTER BARRET LEVELS AT THE POINT OF CONNECTION FOR ALL DRAINAGE PRIOR TO THE COMMENCEMENT OF ANY DRAINAGE CONSTRUCTION.
- FOR EACH TYPE OF ABOVE GROUND FOU DRAINAGE CONNECTIONS REFER TO RELEVANT ARCHITECTS DRAWINGS.
- ALL PIPEWORK CONNECTING TO THE ADOPTABLE MANHOLES OR SEWERS, ARE TO BE 300mm MINIMUM DIAMETER VENTRIED GULLY AND LAID TO CONNECT WITH LEVEL SOFFITS.

REV	DATE	DESCRIPTION	DRW	CHKD
J	02.08.22	CHANGES TO FLAT DRAINAGE AS CLOUDED	JJT	KRT
H	30.06.22	TEMPORARY FW RISING MAIN SERVING COMPOUND REMOVED	SLS	JRT
G	21.06.22	REVISIONS TO SUIT UTILITY SERVICES REVIEW	KRT	JJT
F	01.04.22	DIFFUSER UNITS PROVIDED TO PERMEABLE ROADS, FW AMENDED TO REDIRECT UNITS TO PIPE TRENCH, FW ROUTE SHOWING DRAINAGE CHANGES TO NHRIC COMMENTS	JJT	KRT
E	17.03.22	AMENDED TO SUIT RAISED RDS LEVELS	JJT	KRT
D	04.03.22	RWPS & SVPS REVIEWED	JJT	KRT
C	11.02.22	SW DRAINAGE AMENDED TO SUIT REDUCTION IN RWPS, SVPS SHOWN TO FOUL DRAIN RUNS, NOTES AMENDED	JJT	KRT
B	15.10.21	ADDITIONAL NOTES AND CONNECTIONS ADD FOR DISCHARGE FROM PERMEABLE PAVING SUBAREA	KRT	JJT
A	24.09.21	REVISED TO SUIT REFMAN AND INCREASED EXTENT OF PHASE 1	DH	KRT

REVISIONS

This drawing is to be read in conjunction with all other Engineer's drawings and all other project information. Any discrepancy between the Engineer's drawings and other project information is to be reported to the Engineer immediately.

Project
**BROAD OAK FARM
STURRY
CANTERBURY**

Title
**PRIVATE DRAINAGE
GENERAL ARRANGEMENT 2**

Client
DAVID WILSON HOMES
WHERE QUALITY LIVES

Richard Jackson
Engineering Consultants

107 The Crescent, Canterbury, Essex CO1 0PE
Tel: 01226 228800
Unit 55C135, 6th Floor, 1 St. Nicholas Way, London, E14 0NR
Tel: 020 2448 9910

5 Queen House, 9th Floor, Great Street, Canterbury, Kent CT2 2JL
Tel: 01222 314700

1 The Old Church, 20, High Street, Norwich, Norfolk NR1 1SP
Tel: 01603 390010

The Whitehouse, Broadway, Stonehouse, Gloucestershire GL10 3SP
Tel: 01122 020010

Web: <http://www.richard-jackson.com>

Scale	Drawn	Date			
1:250 @ A1	DCH	JULY 2021			
Project Manager	Checked	Approved			
K. TOSH	JJT	KRT			
Status	Suitability Description	R/JL Project No :			
D2	FOR TENDER	61109			
Project Code	Discipline	Phase	Client	Ref No	Revision
H8398	CIV	X	BDW	4221	J