





# Map Key

Bedrock geology 1:50,000 scale

-  [THANET FORMATION - SAND, SILT AND CLAY](#)
-  [HARWICH FORMATION - SAND AND GRAVEL](#)
-  [LONDON CLAY FORMATION - CLAY AND SILT](#)
-  [SEAFORD CHALK FORMATION - CHALK](#)
-  [LAMBETH GROUP - SAND](#)
-  [MARGATE CHALK MEMBER - CHALK](#)

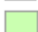
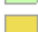
**Appendix D - Greenfield Runoff Rates**

Calculated by: Jamie Finch  
 Site name: Jocks & Morello  
 Site location: Goose Farm, Broad Oak, Sturry

Site coordinates  
 Latitude: 51.30970° N  
 Longitude: 1.09812° E

This is an estimation of the greenfield runoff rate limits that are needed to meet normal best practice criteria in line with Environment Agency guidance "Preliminary rainfall runoff management for developments", W5-074/A/TR1/1 rev. E (2012) and the SuDS Manual, C753 (Ciria, 2015). This information on greenfield runoff rates may be the basis for setting consents for the drainage of surface water runoff from sites.

Reference: 6084139  
 Date: 2017-08-27T19:44:26

Methodology	IH124
-------------	-------

### Site characteristics

Total site area (ha)	11.65
----------------------	-------

### Methodology

Qbar estimation method	Calculate from SPR and SAAR
SPR estimation method	Calculate from SOIL type

	Default	Edited
SOIL type	4	4
HOST class	---	---
SPR/SPRHOST	0.47	0.47

### Hydrological characteristics

	Default	Edited
SAAR (mm)	631	631
Hydrological region	7	7
Growth curve factor: 1 year	0.85	0.85
Growth curve factor: 30 year	2.3	2.3
Growth curve factor: 100 year	3.19	3.19

### Notes:

(1) Is $Q_{BAR} < 2.0$ l/s/ha?
(2) Are flow rates < 5.0 l/s?
(3) Is $SPR/SPRHOST \leq 0.3$ ?

### Greenfield runoff rates

	Default	Edited
Qbar (l/s)	49.81	49.81
1 in 1 year (l/s)	42.34	42.34
1 in 30 years (l/s)	114.57	114.57
1 in 100 years (l/s)	158.91	158.91

**Appendix E - Development Proposals**



**Goose Farm**  
**Broad Oak, Sturry,**  
**Canterbury. CT2 0QL**

**Location Plan 070817v1**

**1:5,000 at A3**

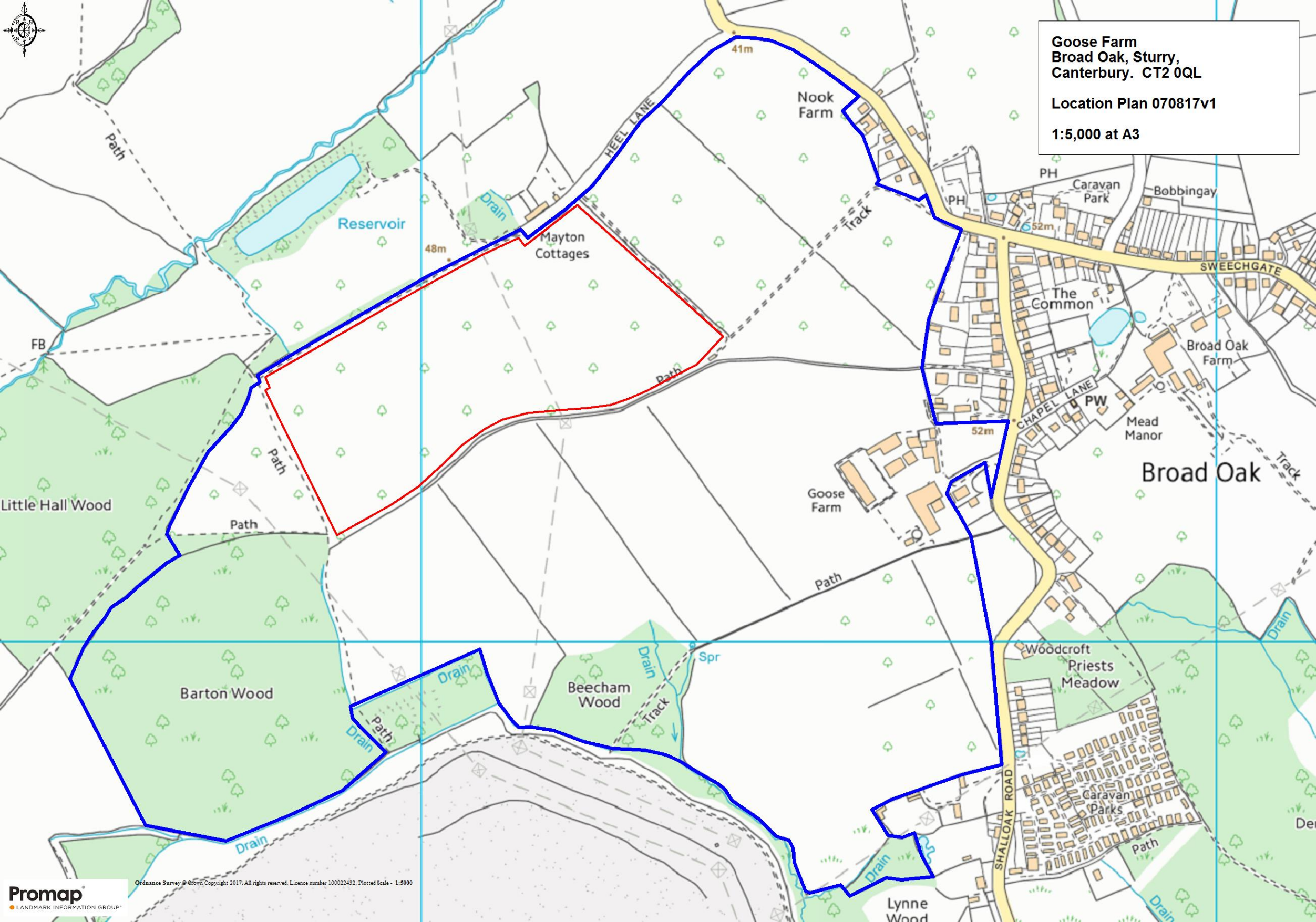



**Proposed Polytunnels  
Land at Goose Farm  
Broad Oak, Sturry,  
Canterbury. CT2 0QL**

**Site Plan - 070817v1  
1:2,500 at A3**

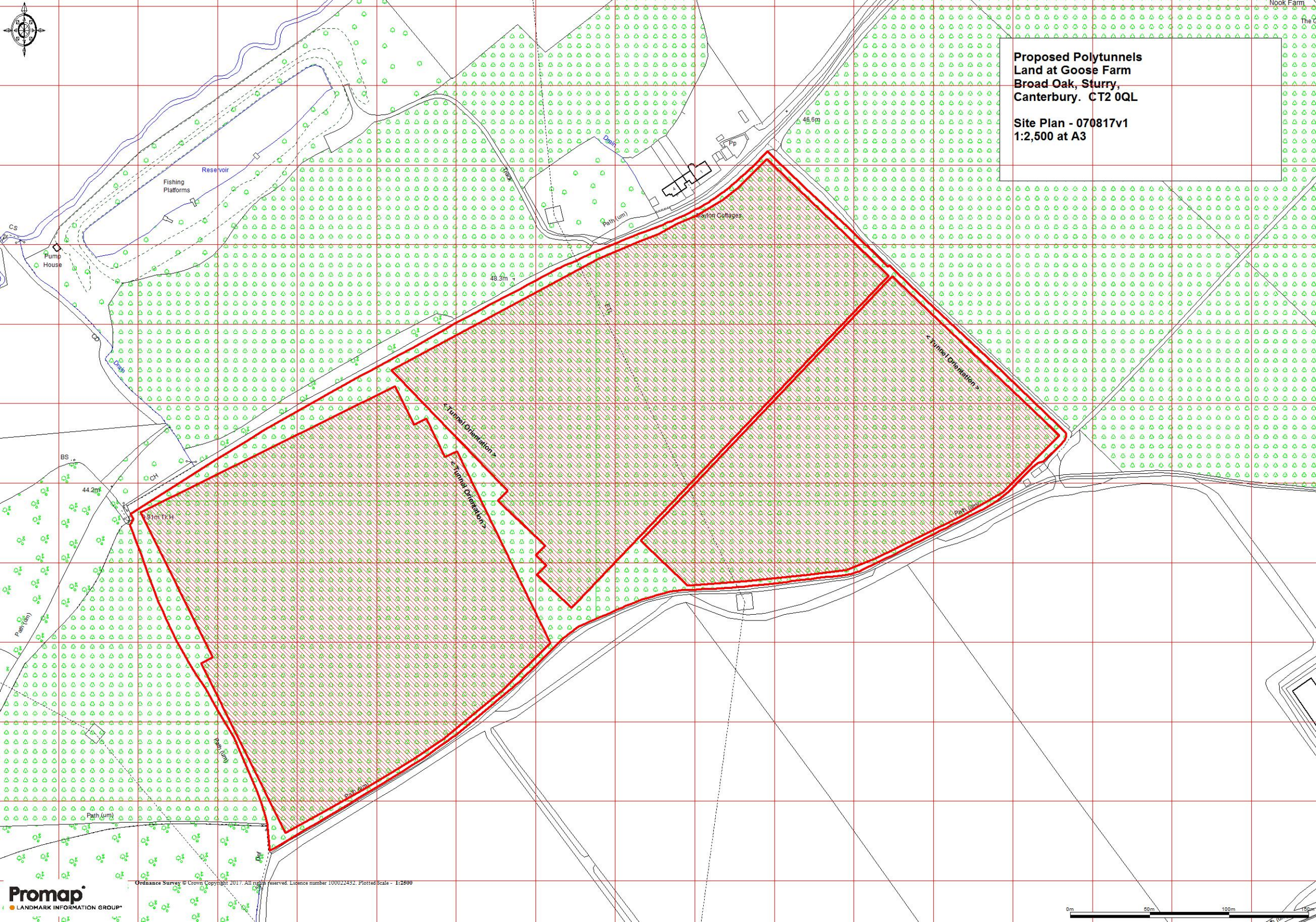



Google



Google

Map Data Terms of Use Report a map error



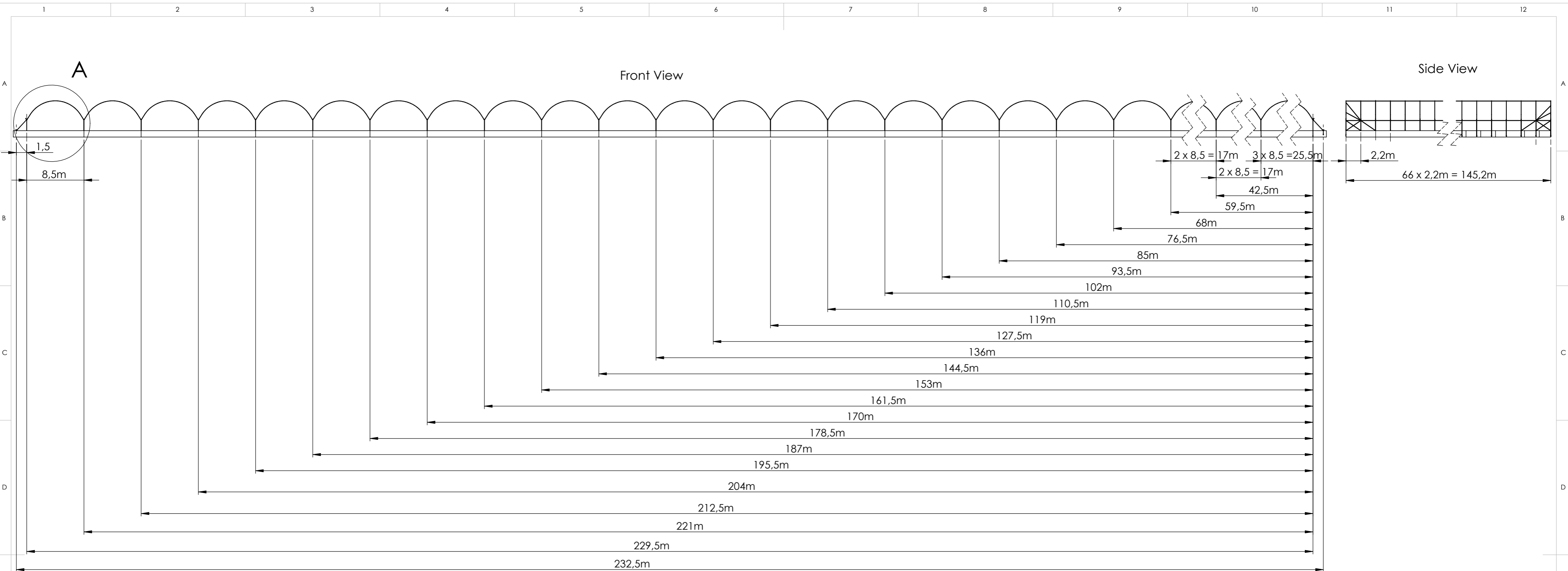

DETAIL A  
SCALE 1 : 50

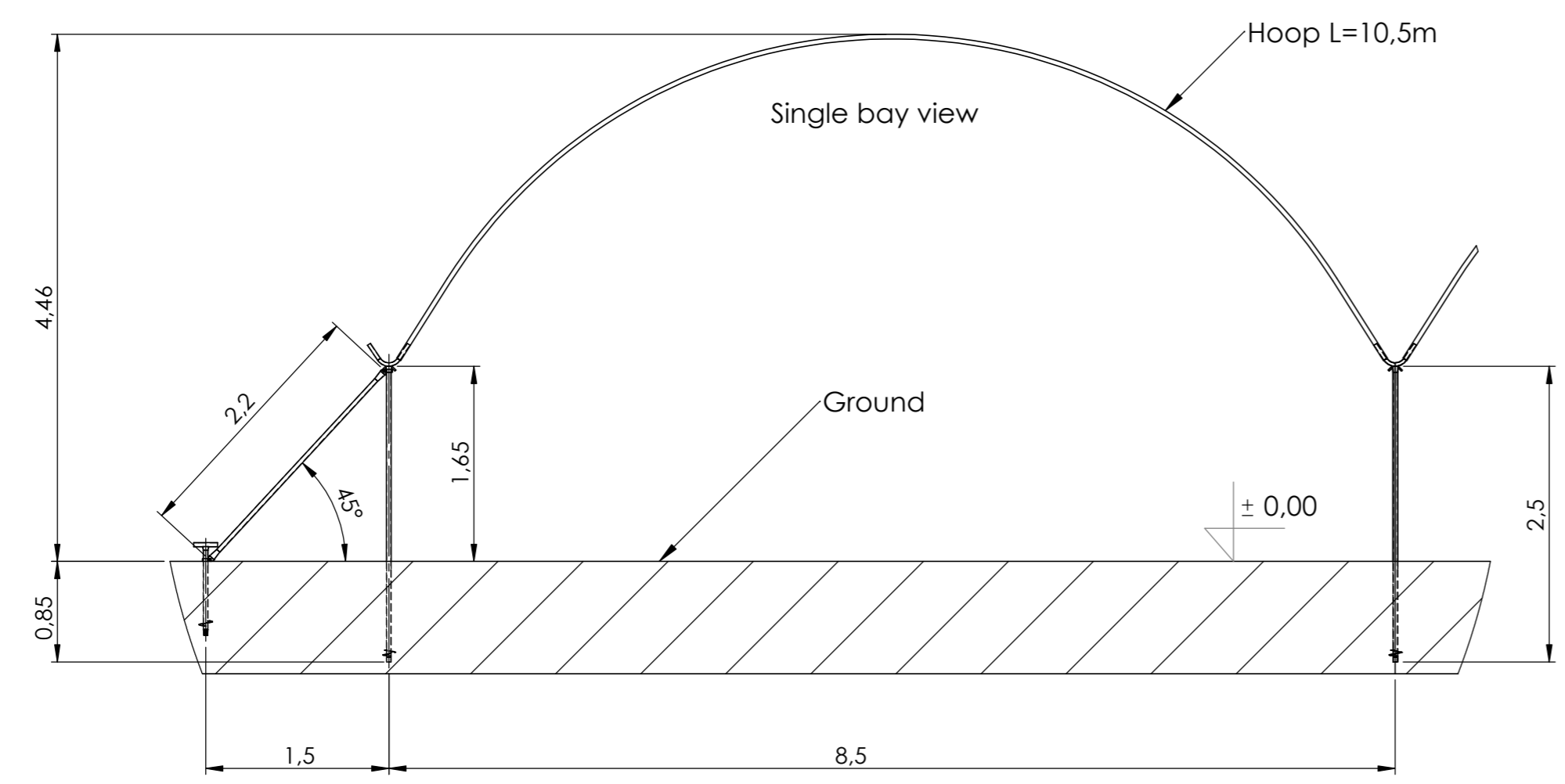

All dimensions ±5%  
All dimensions in meters

**IF IN DOUBT ASK DEBUR AND BREAK SHARP EDGES / WSZYSTKIE OSTRE KRAWĘDZIE STĘPIĆ**  
**Masz wątpliwość? pytaj!**  
ALL DIMENSIONS IN MM UNLESS STATED  
 DO NOT SCALE DRAWING  
 Wszystkie wymiary w milimetrach jeśli nie zaznaczono inaczej

This document is confidential and the copyright therein are the property of PROGRESS. The document and any information therein may not be used, copied or disclosed to any third party without the prior written authorisation of PROGRESS. Ten dokument jest własnością firmy PROGRESS. Wykorzystanie lub kopiowanie elementów lub rysunku bez zgody firmy PROGRESS, jest zabronione.

Material/Material: \_\_\_\_\_  
 Weight/Cieężar: \_\_\_\_\_  
 Drawn/Rys.: gleszczynski Date/Data: 2017-05-16  
 Checked/Spr.: \_\_\_\_\_ Date/Data: \_\_\_\_\_  
 Approved/Zatw.: \_\_\_\_\_ Date/Data: \_\_\_\_\_

TITLE: OPIS: **Jocks 1**

Haygrove Ltd  
 Redbank, Ledbury  
 Herefordshire U.K.  
 Tel: 44 (0)1531 635041  
 Info@haygrove.co.uk

DWG No: TA02079  
 NR RYS.: \_\_\_\_\_  
 SCALE: 1:400 SHEET: 1 of 2 REVISION: 1  
 SKALA: \_\_\_\_\_ ARKUSZ: \_\_\_\_\_

Top View

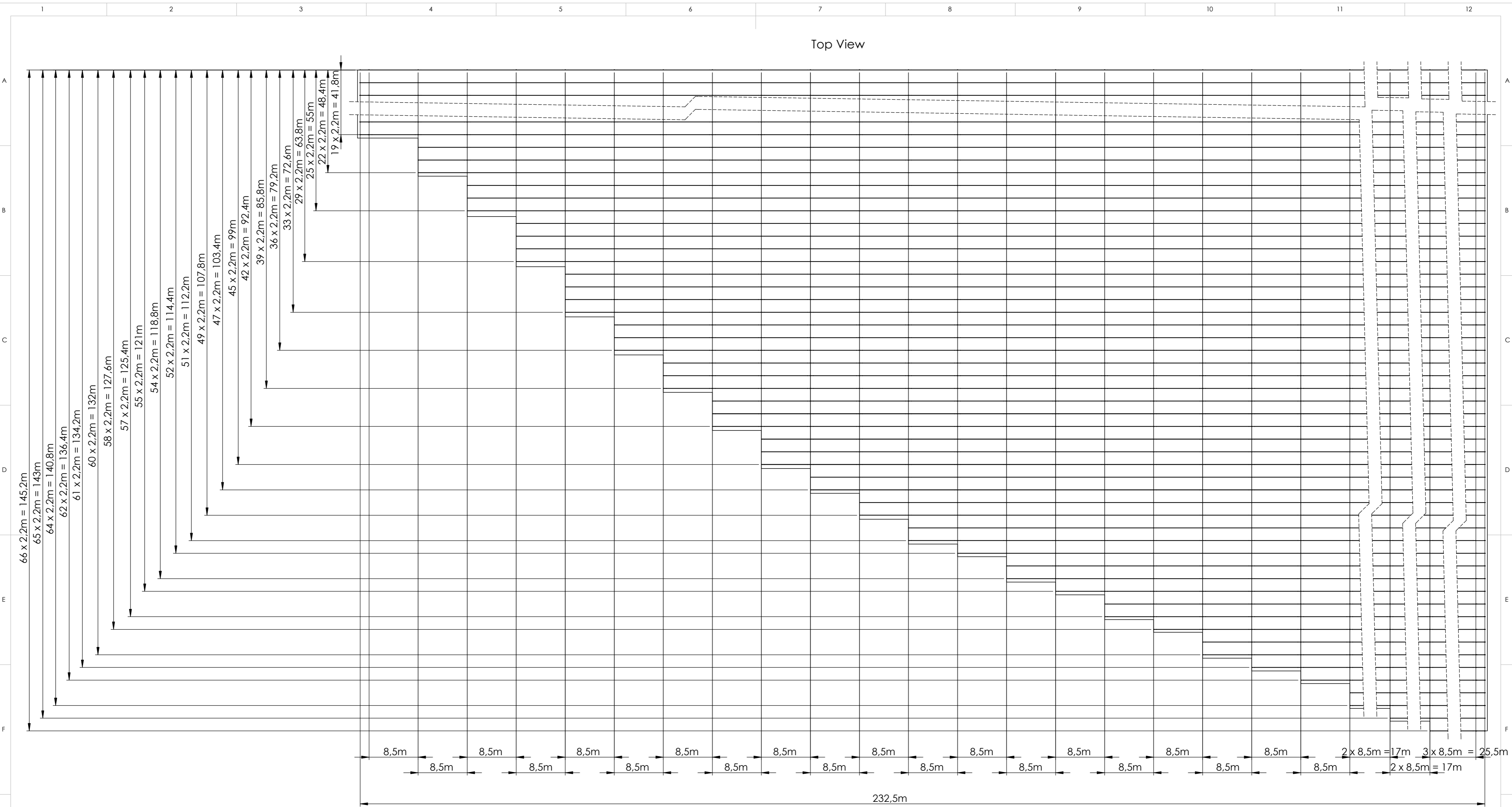

**IF IN DOUBT ASK DEBUR AND BREAK SHARP EDGES / WSZYSTKIE OSTRE KRAWĘDZIE STĘPIĆ**  
**Masz wątpliwość pytaj**  
ALL DIMENSIONS IN MM UNLESS STATED  
 DO NOT SCALE DRAWING  
 Wszystkie wymiary w milimetrach jeśli nie zaznaczono inaczej

This document is confidential and the copyright therein are the property of PROGRESS. The document and any information therein may not be used, copied or disclosed to any third party without the prior written authorisation of PROGRESS. Ten dokument jest własnością firmy PROGRESS. Wykorzystanie lub kopiowanie elementów lub rysunku bez zgody firmy PROGRESS, jest zabronione.

**Material/Material:**  
**Weight/Cieężar:**

Drawn/Rys.	Date/Data	Checked/Spr.	Date/Data	Approved/Zatw.	Date/Data
głuszczynski	2017-05-16				

**TITLE:** OPIS  
**Jocks 1**

**Haygrove tunnels**  
 Haygrove Ltd  
 Redbank, Ledbury  
 Herefordshire U.K.  
 Tel: 44 (0)1531 635041  
 Info@haygrove.co.uk

DWG No: TA02079  
 SCALE: 1:450  
 SHEET: ARKUSZ: 2 of 2  
 REVISION: 1  
 REVIZJA:

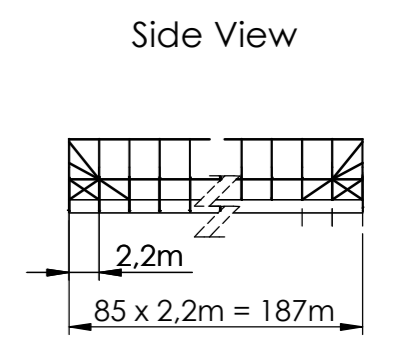
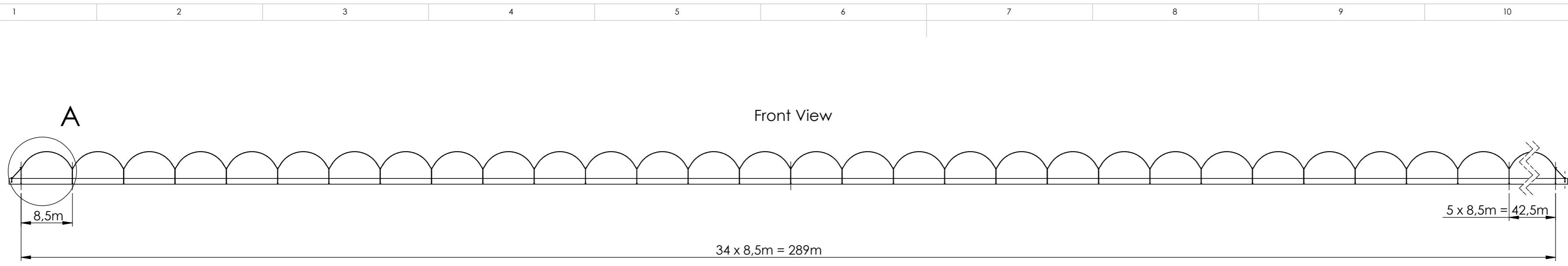

DETAIL A  
SCALE 1 : 50

Single bay view

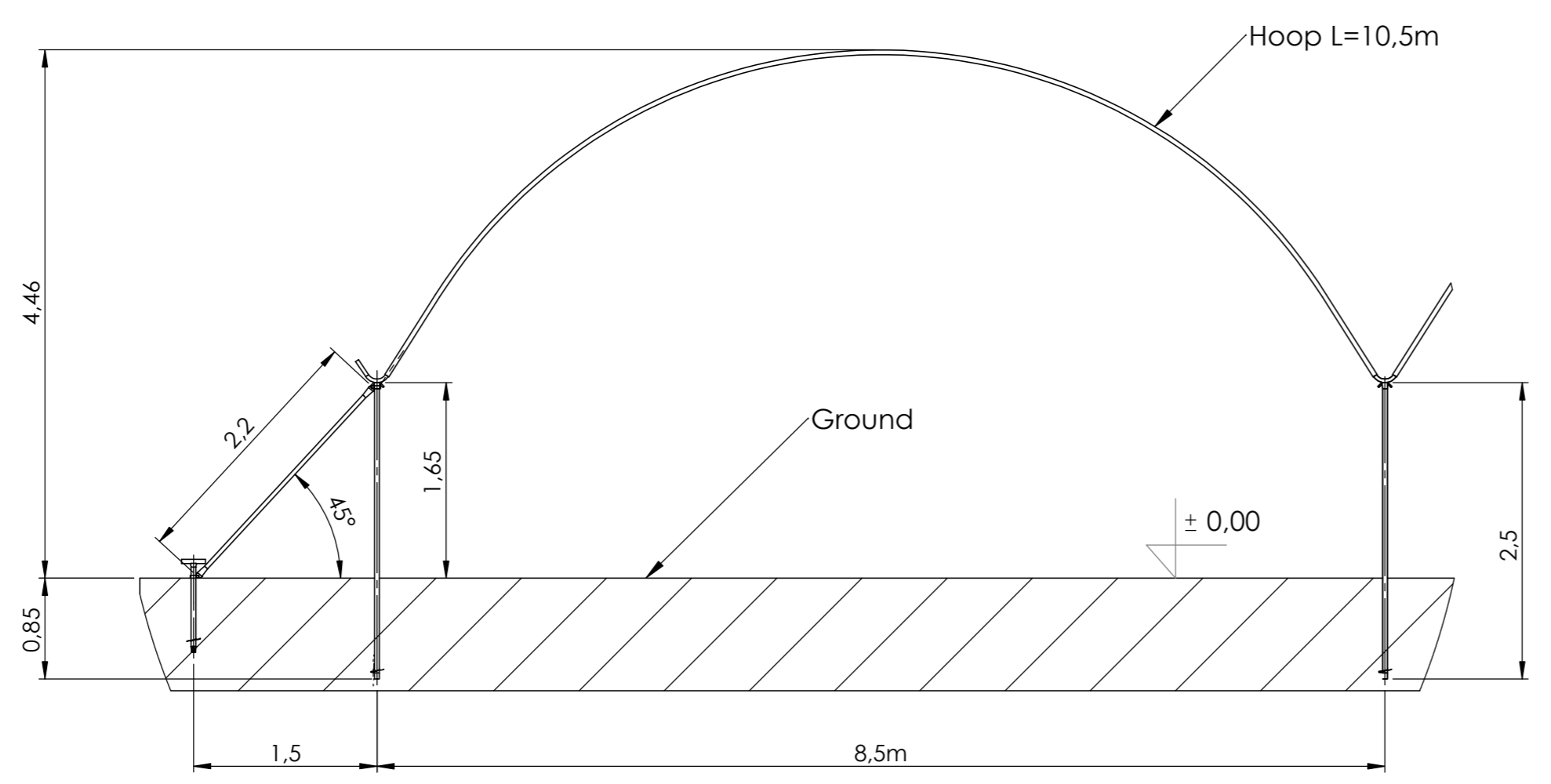

All dimensions ±5%  
All dimensions in meters

**IF IN DOUBT ASK DEBUR AND BREAK SHARP EDGES / WSZYSTKIE OSTRE KRAWĘDZIE STĘPIĆ**  
**Masz wątpliwość pytaj**  
ALL DIMENSIONS IN MM UNLESS STATED  
 DO NOT SCALE DRAWING  
 Wszystkie wymiary w milimetrach jeśli nie zaznaczono inaczej

This document is confidential and the copyright therein are the property of PROGRESS. The document and any information therein may not be used, copied or disclosed to any third party without the prior written authorisation of PROGRESS. Ten dokument jest własnością firmy PROGRESS. Wykorzystanie lub kopiowanie elementów lub rysunku bez zgody firmy PROGRESS, jest zabronione.

Material/Material: \_\_\_\_\_  
 Weight/Cieężar: \_\_\_\_\_

Drawn/Rys.	Date/Data	Checked/Spr.	Date/Data	Approved/Zatw.	Date/Data
głuszczynski	2017-05-16				

TITLE: **Jocks 2**  
 OPIS: \_\_\_\_\_

Haygrove Ltd  
 Redbank, Ledbury  
 Herefordshire U.K.  
 Tel: 44 (0)1531 635041  
 Info@haygrove.co.uk

DWG No: **TA02080**  
 NR RYS.: \_\_\_\_\_  
 SCALE: 1:550  
 SKALA: \_\_\_\_\_

HG No: \_\_\_\_\_  
 REVISION: 1  
 REWIZJA: \_\_\_\_\_

1 of 2

Top View

292m

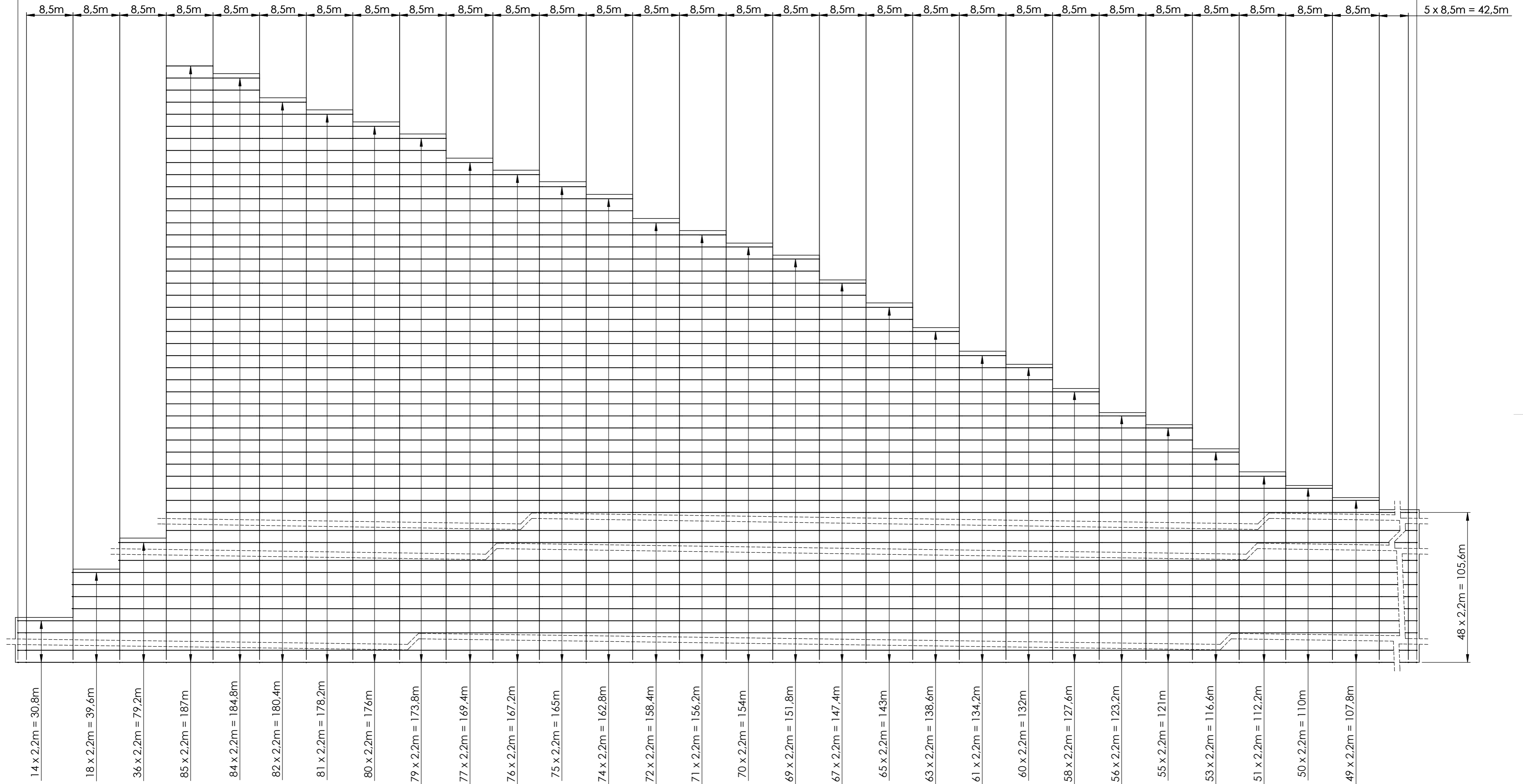

**IF IN DOUBT ASK DEBUR AND BREAK SHARP EDGES / WSZYSTKIE OSTRE KRAWĘDZIE STĘPIĆ**  
**Masz wątpliwości pytaj**  
ALL DIMENSIONS IN MM UNLESS STATED  
 DO NOT SCALE DRAWING  
 Wszystkie wymiary w milimetrach jeśli nie zaznaczono inaczej

This document is confidential and the copyright therein are the property of PROGRESS. The document and any information therein may not be used, copied or disclosed to any third party without the prior written authorisation of PROGRESS. Ten dokument jest własnością firmy PROGRESS. Wykorzystanie lub kopiowanie elementów lub rysunku bez zgody firmy PROGRESS, jest zabronione.

Material/Material: \_\_\_\_\_  
 Weight/Ciężar: \_\_\_\_\_  
 Drawn/Rys.: gleszczynski Date/Data: 2017-05-16 Checked/Spr.: \_\_\_\_\_ Date/Data: \_\_\_\_\_ Approved/Zatw.: \_\_\_\_\_ Date/Data: \_\_\_\_\_

**Haygrove tunnels**  
 Haygrove Ltd  
 Redbank, Ledbury  
 Herefordshire U.K.  
 Tel: 44 (0)1531 635041  
 Info@haygrove.co.uk

DWG No: TA02080  
 NR RYS.: \_\_\_\_\_  
 SCALE: 1:500  
 SHEET: ARKUSZ: 2 of 2  
 TITLE: OPIS: **Jocks 2**  
 HG No: \_\_\_\_\_  
 REVISION: 1  
 REWIZJA: \_\_\_\_\_

All dimensions ±5%  
All dimensions in meters

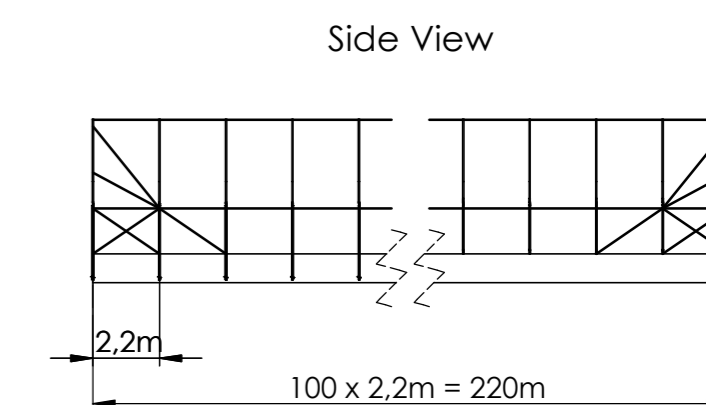
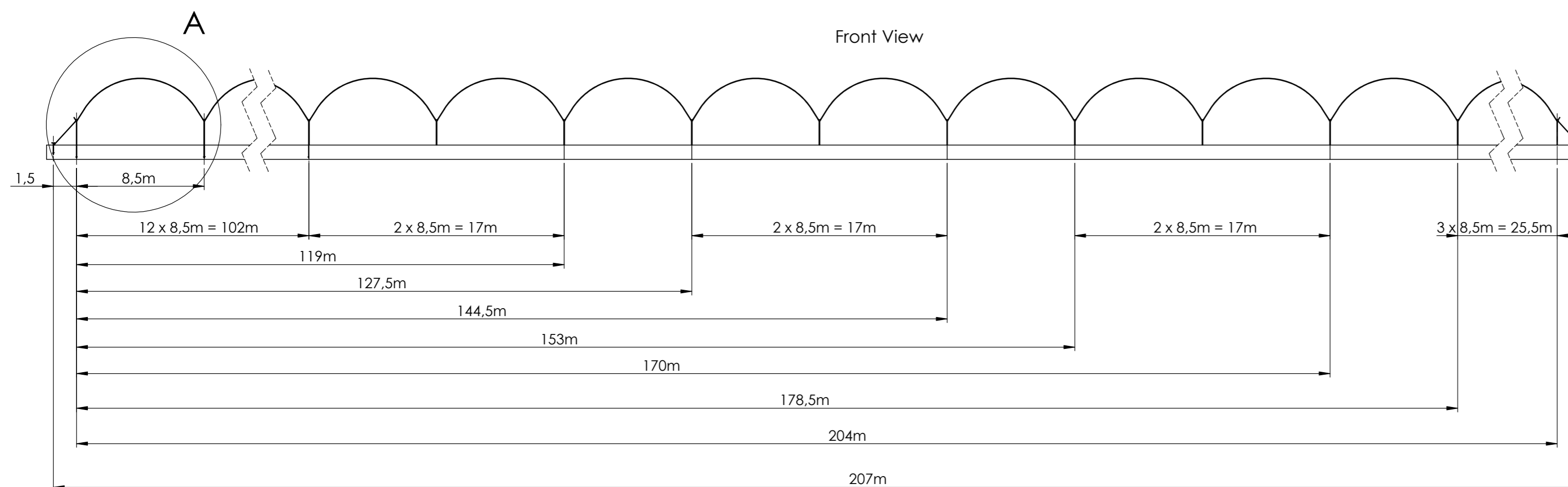

DETAIL A  
SCALE 1 : 50

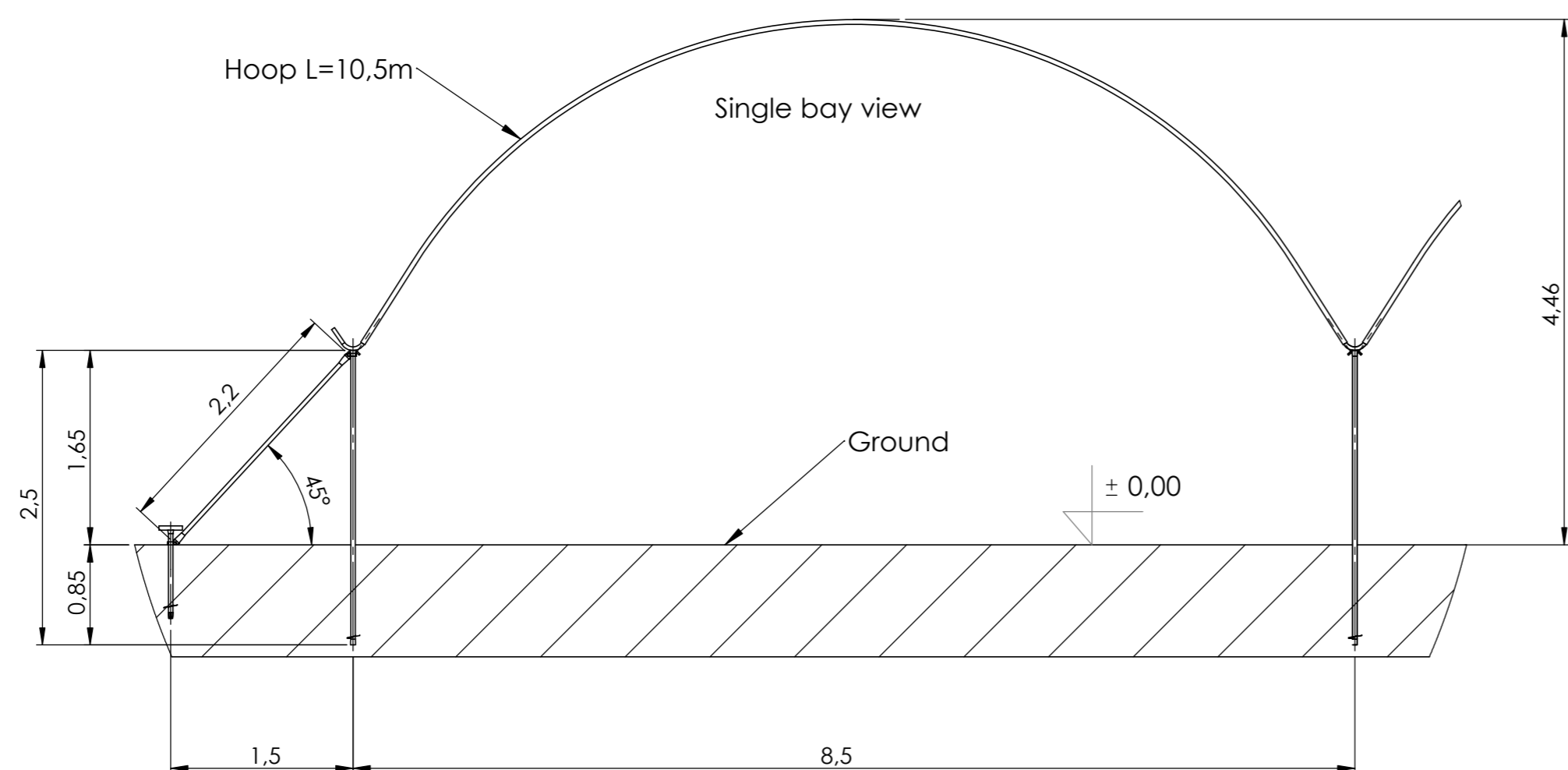

IF IN DOUBT ASK DEBUR AND BREAK SHARP EDGES / WSZYSTKIE OSTRE KRAWĘDZIE STĘPIĆ

ALL DIMENSIONS IN MM UNLESS STATED  
DO NOT SCALE DRAWING  
Wszystkie wymiary w milimetrach jeśli nie zaznaczono inaczej

Masz wątpliwości? **pytaj**

This document is confidential and the copyright therein are the property of PROGRESS. The document and any information therein may not be used, copied or disclosed to any third party without the prior written authorisation of PROGRESS. Ten dokument jest własnością firmy PROGRESS. Wykorzystanie lub kopiowanie elementów lub rysunku bez zgody firmy PROGRESS, jest zabronione.

Material/Material: \_\_\_\_\_

Weight/Cieężar: \_\_\_\_\_

Drawn/Rys. gleszczynski	Date/Data 2017-05-15	Checked/Spr. _____	Date/Data _____	Approved/Zatw. _____	Date/Data _____
-------------------------	----------------------	--------------------	-----------------	----------------------	-----------------

TITLE: OPIS: **Morello**

Haygrove Ltd  
Redbank, Ledbury  
Herefordshire U.K.  
Tel: 44 (0)1531 635041  
Info@haygrove.co.uk

DWG No: TA02081  
NR RYS.: \_\_\_\_\_  
SCALE: 1:250  
SKALA: 1:250

HG No: \_\_\_\_\_  
SHEET: 1 of 2  
ARKUSZ: 1 of 2

REVISION: 1  
REWIZJA: 1

Top View

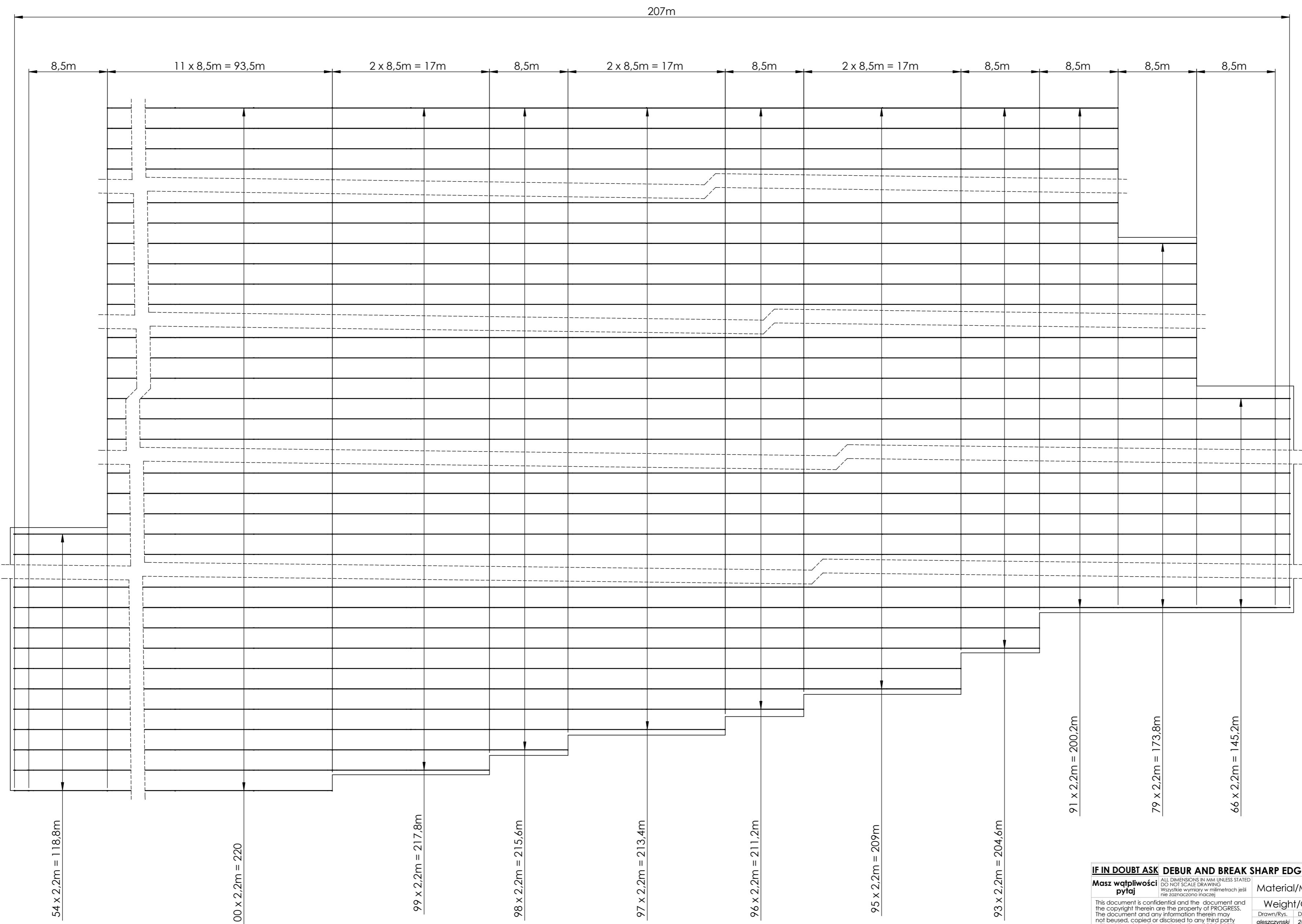

**IF IN DOUBT ASK DEBUR AND BREAK SHARP EDGES / WSZYSTKIE OSTRE KRAWĘDZIE STĘPIĆ**  
**Masz wątpliwość pytaj**

ALL DIMENSIONS IN MM UNLESS STATED  
 DO NOT SCALE DRAWING  
 Wszystkie wymiary w milimetrach jeśli nie zaznaczono inaczej

This document is confidential and the copyright therein are the property of PROGRESS. The document and any information therein may not be used, copied or disclosed to any third party without the prior written authorisation of PROGRESS. Ten dokument jest własnością firmy PROGRESS. Wykorzystanie lub kopiowanie elementów lub rysunku bez zgody firmy PROGRESS, jest zabronione.

Material/Material: \_\_\_\_\_  
 Weight/Cieężar: \_\_\_\_\_  
 Drawn/Rys.: gleszczynski Date/Data: 2017-05-15  
 Checked/Spr.: \_\_\_\_\_ Date/Data: \_\_\_\_\_  
 Approved/Zatw.: \_\_\_\_\_ Date/Data: \_\_\_\_\_

TITLE: **Morello**  
 OPIS: \_\_\_\_\_

Haygrove Ltd  
 Redbank, Ledbury  
 Herefordshire U.K.  
 Tel: 44 (0)1531 635041  
 Info@haygrove.co.uk

DWG No: TA02081  
 NR RYS.: \_\_\_\_\_  
 SCALE: 1:300  
 SKALA: \_\_\_\_\_

HG No: \_\_\_\_\_  
 SHEET: 2 of 2  
 ARKUSZ: \_\_\_\_\_

REVISION: 1  
 REWIZJA: \_\_\_\_\_



**Appendix F - Drainage Strategy Drawings**

**Appendix F - Drainage Strategy Drawings**