

MH	VOLUME (m³)
71	446.40
94	99.75
121	152.00
115	93.00
123	163.88
101	36.10
111	28.50
55	595.20
36	97.80
81	139.50
83	217.62
46	35.34
47	50.92
48	41.80
75	251.10
77	195.30
92	251.10
113	208.32
100	148.80
110	127.64
93	83.7
114	125.55
99	186.00
109	302.25
117	272.03
119	418.50
23	439.15
29	892.80
49	1,159.00
89	2,223.00
TOTAL VOLUME	9,482.05

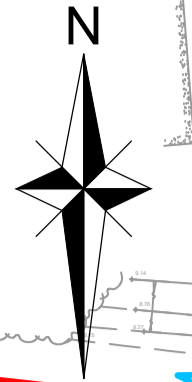

KEY	
	SITE BOUNDARY
	SURFACE WATER MANHOLE
	SURFACE WATER PIPE
	PERMEABLE PAVING
	PROPOSED BASIN
	STORAGE CRATES
	PROPOSED HEADWALL
	PROPOSED CONTROL
	1% AEP FLOODING
	0.1% AEP FLOODING

- NOTES**
- DO NOT SCALE FROM THIS DRAWING WORK FROM FIGURED DIMENSIONS ONLY.
 - ALL MEASUREMENTS SHOWN IN METERS UNLESS NOTED OTHERWISE.
 - ATTENUATED VOLUME APPLIES TO SURFACE WATER ONLY.
 - DRAINED CATCHMENT AREA - 12.32Ha
 - ALLOWABLE DISCHARGE RATE - 49.3l/s (BASED ON 4l/s/ha)

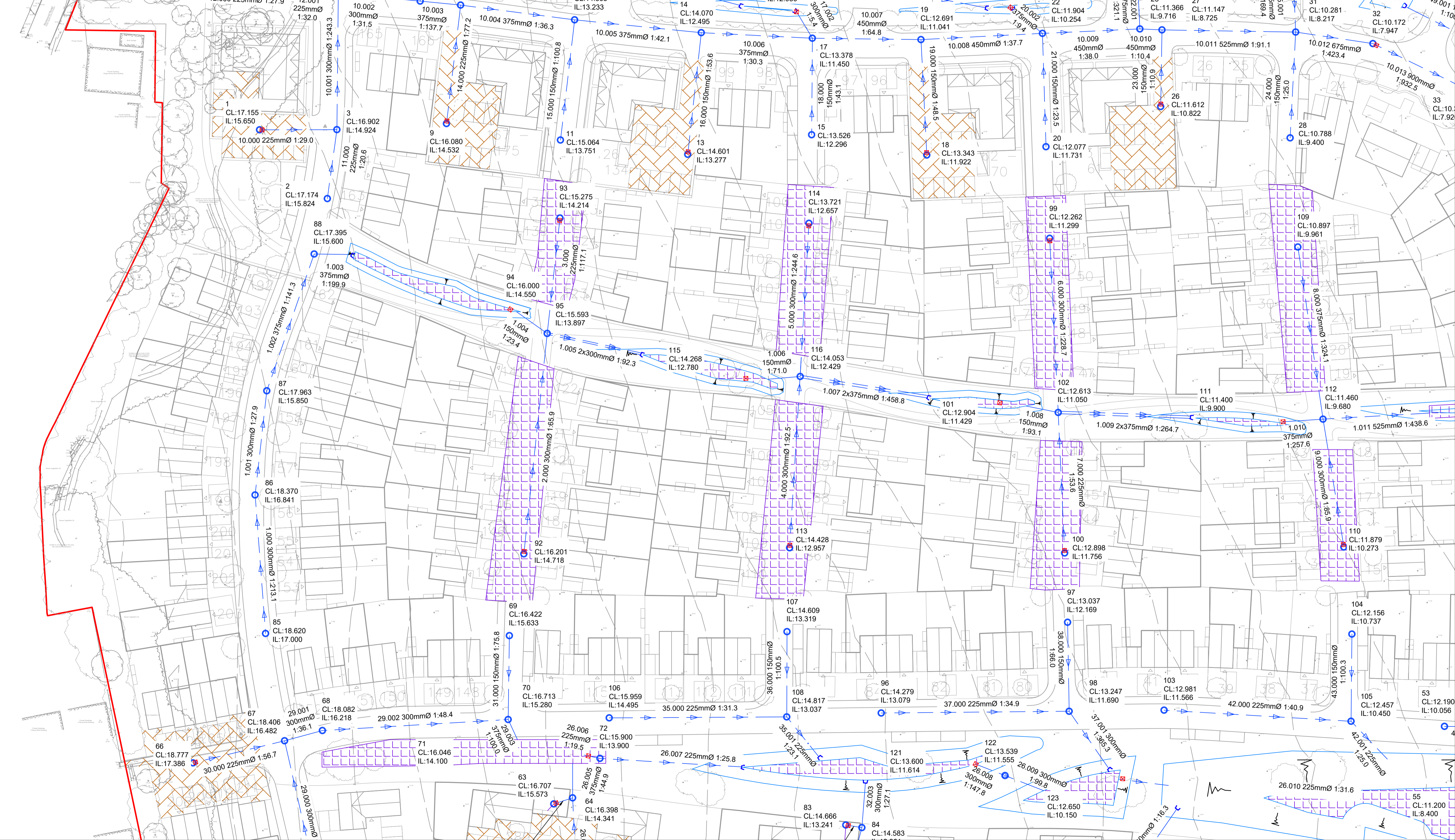

PD2	SW REVISED	MM	MM	JM	08/02/21
REV	DESCRIPTION	DE	DR	CH	DATE
MM	DESIGNED BY	DL	DRAWN BY	MM	CHECKED BY
1:500	SCALE @ A1 SIZE	08/10/20	DATE		
PROJECT TITLE					
GRASMERE GARDENS, CHESTFIELD, KENT					
DRAWING TITLE					
SURFACE WATER LAYOUT SHEET 1 OF 3					
CLIENT					
KITEWOOD ESTATES LTD					
CANNON CONSULTING ENGINEERS Highways, Transport & Infrastructure Planning					
Peek House, 20 Eastcheap London, EC3M 1EB Tel: 020 7717 5870 info@cannonco.co.uk			Cambridge House, Lanwades Business Park, Kentford, Newmarket, CB8 7PN Tel: 01638 656107 www.cannonco.co.uk		
DRAWING NUMBER					REV.
S102-PL-DR-200					P02

L15102 Grasmere Gardens, Chestfield, Kent S102-PL-DR-200 - 202 SW Layout