

- Notes**
- © Copyright Alan Baxter Partnership LLP
 - This drawing & design is the copyright of Alan Baxter Partnership LLP and must not be copied in part or whole without consent.
 - Do not scale off this drawing
 - 1. To be read in conjunction with all Architects and Engineers drawings
 - 2. Level design is based on information from a topographical survey provided by others. Alan Baxter Partnership LLP takes no responsibility for the accuracy of the original topographical survey. All existing levels are to be confirmed by the contractor prior to the commencement of the works.
 - 3. All discrepancies to be notified immediately to contract administrator and engineers.
 - 4. Only 'Construction' drawings shall be used for construction or the ordering of materials. Any other drawings (tender / billing / work in progress etc.) drawings shall not be used for this purpose.
 - 5. All rainwater pipe (RWP), soil vent pipe (SVP) and stub stack (SS) locations are approximate. Refer to Architects drawings for exact locations.
 - 6. Stub stacks (SS) are to incorporate air admittance valves.
 - 7. The invert level of the bottom bends for all SVPs and SSs are to be 450mm below F.F.L.
 - 8. Channel Drains to be ACO Multidrain MD (refer to channel drain run calculations). Grating Finish to Architects Specification.
 - 9. Refer to drawings W1114-0500-010, 011 & 012 for construction details.

- Key**
- Existing**
- Surface Water (Retained)
 - Carrier Pipe
 - Chamber
 - Foul Water (Retained)
 - Carrier Pipe
 - Manhole
- Abandoned**
- Carrier Pipe (Surface Water)
 - Carrier Pipes (Foul Water)
- Proposed**
- Surface Water (Private)**
- RWP - Rainwater Pipe (refer to note 5)
 - Carrier Pipe (100mm UPVC unless stated otherwise)
 - Filter Pipe
 - Rodding Eye (with ref. no.)
 - Inspection Chamber (with ref. no.)
 - Catchpit Chamber (with ref. no.)
 - Channel Drain (refer to note 8)
 - Channel Drain Access Point
 - Permeable Paving (Sub-Base Storage)
 - Road Gully
 - Flow Control Chamber
- Foul Water (Private)**
- SVP/SS - Soil Vent Pipe / Stub Stack (refer to notes 5, 6 and 7)
 - Carrier Pipe (100mm UPVC unless stated otherwise)
 - Inspection chamber (with ref. no.)
 - Manhole chamber (with ref. no.)
 - Site Boundary (approximate)

For connection to public sewer see Inset 1

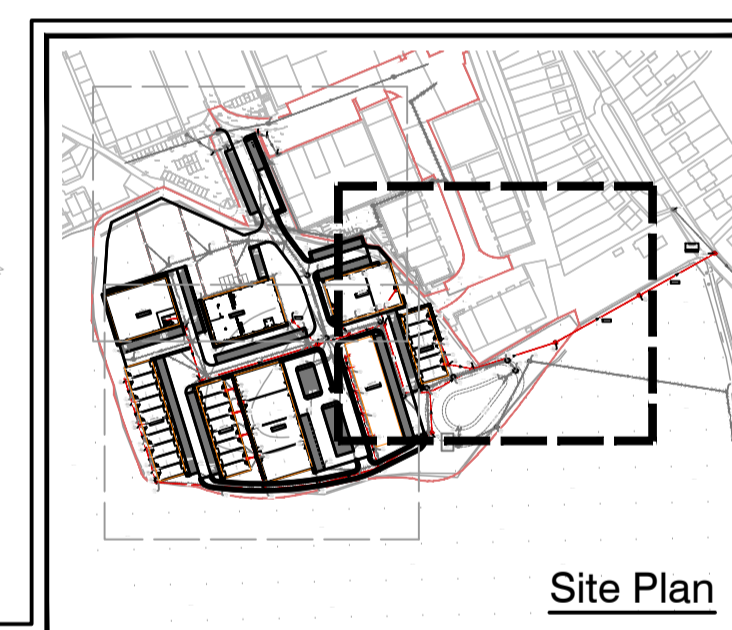

FOR APPROVAL

-			
A	SITE LAYOUT REVISED	JB	30/07/2021
0	FIRST ISSUE	JB ARWS	20/07/2021

ALAN BAXTER PARTNERSHIP LLP
 CONSULTING STRUCTURAL ENGINEERS
 THE CLOCK BUILDING
 PYMPS COURT
 BUSBRIDGE ROAD
 LOOSE
 MAIDSTONE
 KENT ME15 0HZ
 TELEPHONE: 01622 744263
 FAX: 01622 749270
 EMAIL: mail@abpengineers.co.uk



Project Title:
 Joseph Wilson Ind. Est. Expansion
 Milstrood Road
 CT5 3PS

Drawing Title:
 Below Ground Drainage
 Foul Water
 General Arrangement
 Sheet 3 of 3

Scale:	1:250 @A1	Do not scale from drawing
Drawing Number:	W1114-0500-006	Rev: A

Inset 1
 Scale 1:200

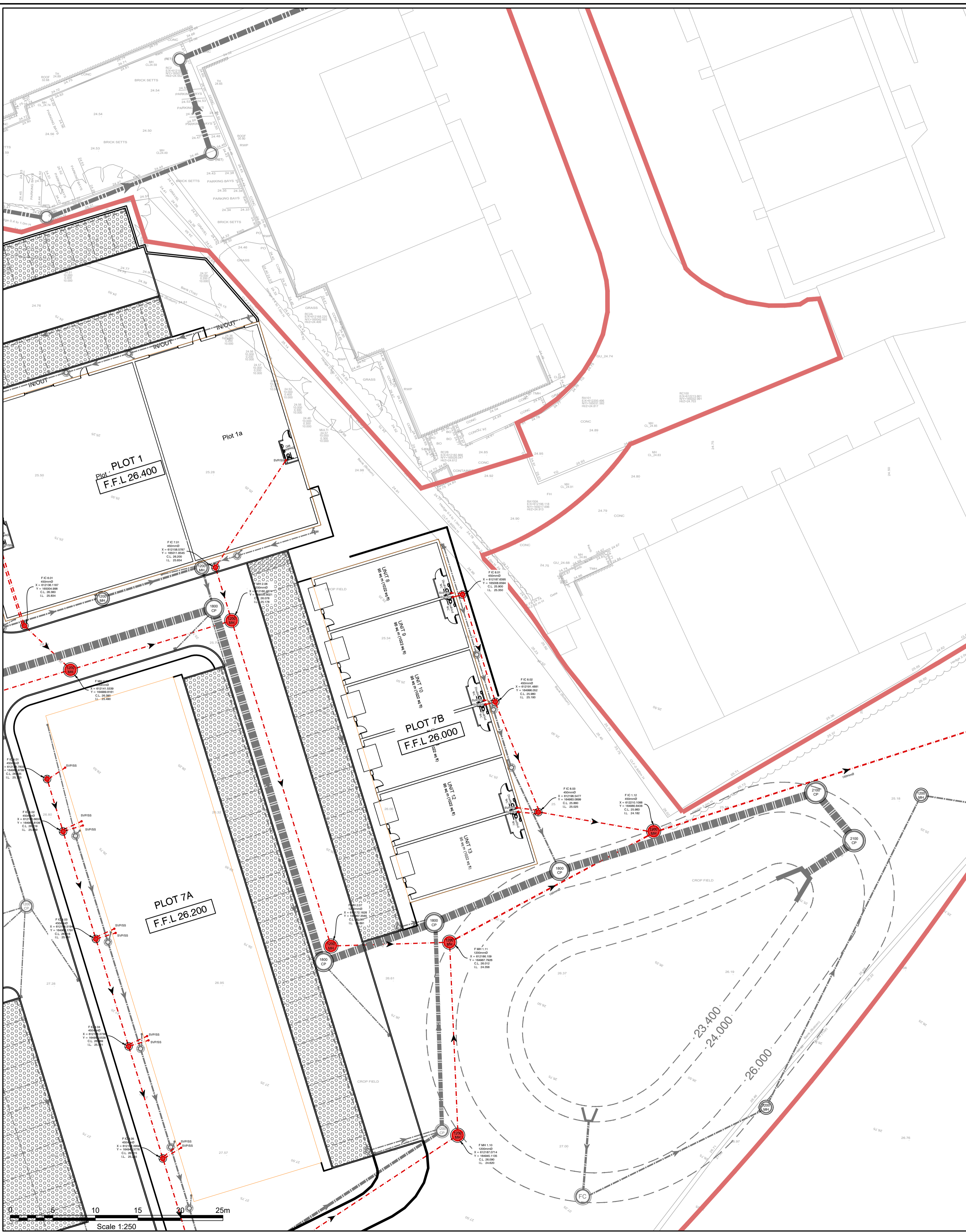
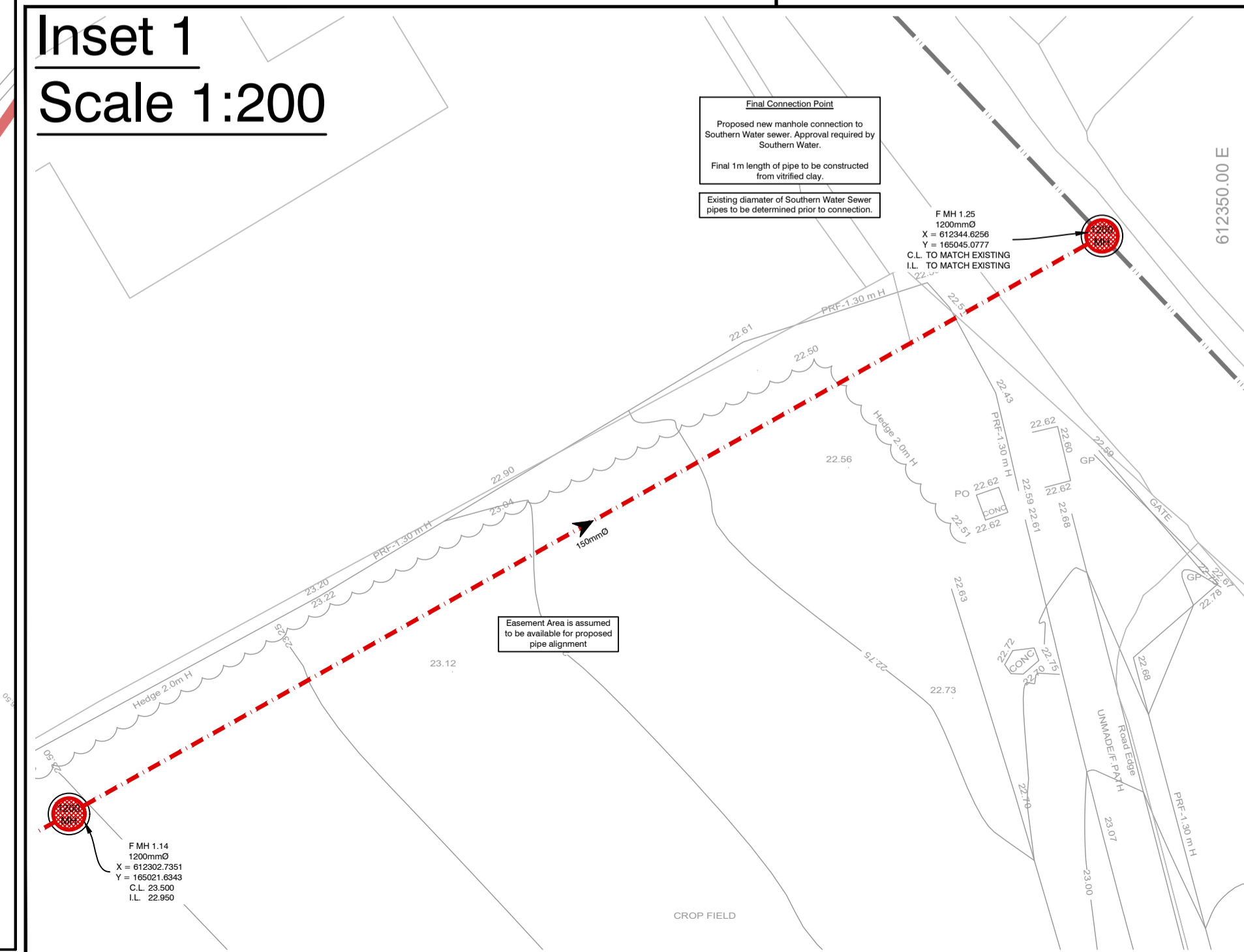

Scale 1:250