

Notes

© Copyright Alan Baxter Partnership LLP

This drawing & design is the copyright of Alan Baxter Partnership LLP and must not be copied in part or whole without consent.

Do not scale off this drawing

- To be read in conjunction with all Architects and Engineers drawings
- Level design is based on information from a topographical survey provided by others. Alan Baxter Partnership LLP takes no responsibility for the accuracy of the original topographical survey. All existing levels are to be confirmed by the contractor prior to the commencement of the works.
- All discrepancies to be notified immediately to contract administrator and engineers.
- Only 'Construction' drawings shall be used for construction or the ordering of materials. Any other drawings (tender / billing / work in progress etc.) drawings shall not be used for this purpose.

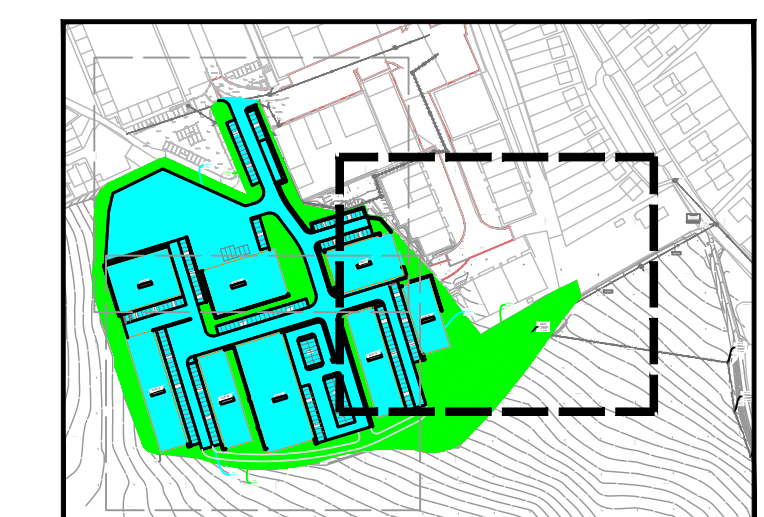

Site Plan

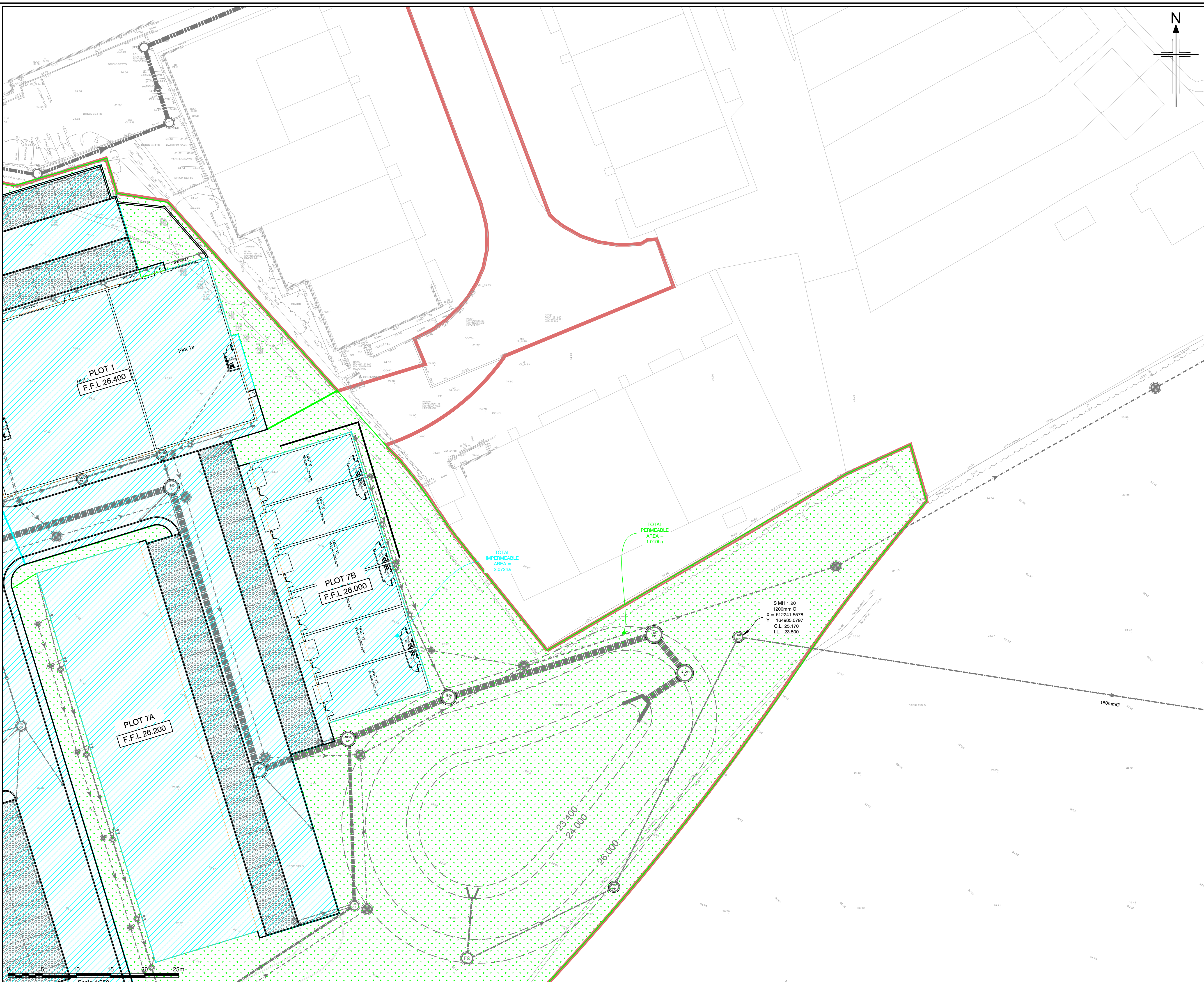

FOR APPROVAL

-			
A	SITE LAYOUT REVISED	JB	30/07/2021
0	FIRST ISSUE	JB ARWS	20/07/2021

ALAN BAXTER PARTNERSHIP LLP
CONSULTING STRUCTURAL ENGINEERS

THE CLOCK BUILDING
PYMPES COURT
BUSBRIDGE ROAD
LOOSE
MAIDSTONE
KENT ME15 0HZ
TELEPHONE: 01622 744263
FAX: 01622 749270
EMAIL: mail@abpengineers.co.uk

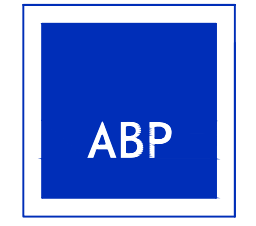

Project Title:
Joseph Wilson Ind. Est. Expansion
Milstrood Road
CT5 3PS

Drawing Title:
Proposed Catchments
Sheet 3 of 3

Scale:	1:250 @A1	Do not scale from drawing
Drawing Number:	W1114-SK-013	Rev: A