

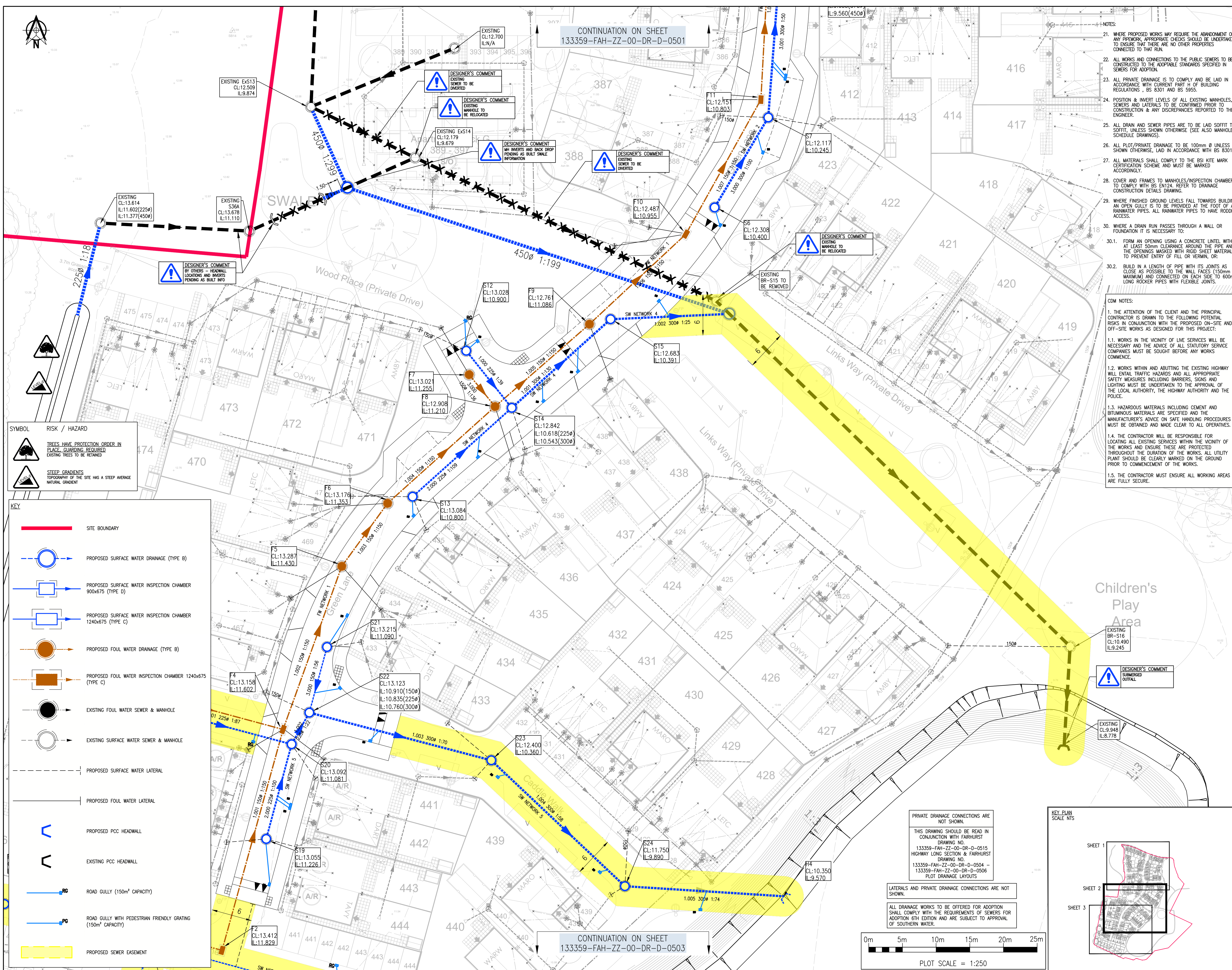

CONTINUATION ON SHEET
133359-FAH-ZZ-00-DR-D-0501



SYMBOL	RISK / HAZARD
	TREES HAVE PROTECTION ORDER IN PLACE. GUARDING REQUIRED. EXISTING TREES TO BE RETAINED.
	STEEP GRADIENTS. TOPOGRAPHY OF THE SITE HAS A STEEP AVERAGE NATURAL GRADIENT.

KEY	DESCRIPTION
	SITE BOUNDARY
	PROPOSED SURFACE WATER DRAINAGE (TYPE B)
	PROPOSED SURFACE WATER INSPECTION CHAMBER 900x675 (TYPE D)
	PROPOSED SURFACE WATER INSPECTION CHAMBER 1240x675 (TYPE C)
	PROPOSED FOUL WATER DRAINAGE (TYPE B)
	PROPOSED FOUL WATER INSPECTION CHAMBER 1240x675 (TYPE C)
	EXISTING FOUL WATER SEWER & MANHOLE
	EXISTING SURFACE WATER SEWER & MANHOLE
	PROPOSED SURFACE WATER LATERAL
	PROPOSED FOUL WATER LATERAL
	PROPOSED PCC HEADWALL
	EXISTING PCC HEADWALL
	ROAD GULLY (150m ² CAPACITY)
	ROAD GULLY WITH PEDESTRIAN FRIENDLY GRATING (150m ² CAPACITY)
	PROPOSED SEWER EASEMENT

- NOTES:
- THIS DRAWING IS TO BE READ IN CONJUNCTION WITH THE RELEVANT SPECIFICATION, INC. RISK ASSESSMENTS (SEE CDM NOTES) AND ALL OTHER RELATED DRAWINGS ISSUED BY THE ENGINEER.
 - ALL DIMENSIONS SHOWN ON THIS DRAWING ARE IN METRES UNLESS OTHERWISE STATED.
 - ALL DIMENSIONS, LEVELS AND SURVEY GRID CO-ORDINATES ARE TO BE CHECKED ON SITE AND THE ENGINEER NOTIFIED IMMEDIATELY OF ANY DISCREPANCIES PRIOR TO THE COMMENCEMENT OF THE WORKS.
 - NO DEVIATION FROM THE DETAILS SHOWN ON THIS DRAWING IS PERMITTED WITHOUT PRIOR PERMISSION FROM THE ENGINEER.
 - ANY WORKS OUTSIDE SITE BOUNDARY ARE FOR INFORMATION PURPOSES ONLY, UNLESS SPECIFICALLY NOTED. ALL WORKS OUTSIDE THE SITE BOUNDARY WILL BE UNDERTAKEN BY OTHERS UNDER A SEPARATE CONTRACT.
 - THE CONTRACTOR SHALL UNDERTAKE SUCH MATERIALS TESTING AS INDICATED IN THE SPECIFICATIONS AND SHALL INCLUDE THE COST OF TESTING IN THE TENDER.
 - ALL EXISTING DRAINAGE TO BE RETAINED SHOULD BE SURVEYED AND REPAIRED IN ACCORDANCE WITH BS EN 1610 CONSTRUCTION AND TESTING OF DRAINS AND SEWERS.
 - STATED COVER LEVELS ARE FOR GUIDANCE ONLY AND SHALL BE SET TO THE FINISH LEVELS OF THE CARPARKWAY/FOOTWAY/VERGE.
 - ALL PIPE SIZES STATED ARE NOMINAL INTERNAL DIAMETERS IN MILLIMETRES.
 - ALL DRAINAGE IS TO BE CONSTRUCTED IN ACCORDANCE WITH THE BUILDING REGULATIONS, BS EN 752 AND RELEVANT AGREEMENT CERTIFICATES.
 - DRAINS TO BE CONSTRUCTED USING FLEXIBLY JOINTED WITHEED CLAY PIPES TO BS 65 'SUPER STRENGTH' SPECIFICATION OR LVC BUILDING DRAINAGE SYSTEM PREWORK TO BS EN 1401, BEDDED AND BACKFILLED IN ACCORDANCE WITH THE MANUFACTURER'S INSTRUCTIONS AND THE SPECIFICATIONS.
 - BACKFILLING OF DRAIN TRENCHES ADJACENT TO DRAINAGES OF OTHER STRUCTURES TO BE IN ACCORDANCE WITH THE BUILDING REGULATIONS PART 4, DIAGRAM B.
 - ALL SOIL VENT PIPE, STUB STACKS, AIR ADMITTANCE VALVES AND RAIN WATER PIPE LOCATIONS ARE INDICATIVE ONLY. FOR ACTUAL LOCATIONS PLEASE REFER TO ARCHITECTS PLANS AND ELEVATIONS.
 - GULLIES SITUATED IN AREAS ACCESSIBLE TO WHEELED VEHICLES WITHIN THE PRIVATE CAR PARKING COURTYARDS TO BE OF SUITABLE CONSTRUCTION WITH IN SITU CONCRETE BED AND SURROUND, FITTED WITH DRAINAGE CASTINGS CODE T651 GRATING AND FRAME (OR SIMILAR APPROVED).
 - SURFACE WATER FROM PRIVATE AREAS IS NOT TO BE DISCHARGED INTO THE PROPOSED HIGHWAY.
 - 2x TELESCOPIC (ELBOW) REST BEND IS TO BE PROVIDED AT THE BASE OF EACH FW STACK.
 - DRAINS IN AREAS OF MADE GROUND TO BE CONSTRUCTED BY FIRST MAKING UP THE AREA TO APPROXIMATELY FINISHED LEVEL AND THEN EXCAVATE THROUGH THE FILL MATERIAL INTO UNDISTURBED GROUND. THE DRAIN TRENCH IS THEN TO BE BACKFILLED TO FORMATION LEVEL USING SUITABLE GRANULAR FILL MATERIAL WELL COMPACTED IN LAYERS NOT EXCEEDING 225mm.
 - A SECTION 106/107 APPLICATION WILL BE REQUIRED PRIOR TO CONNECTION TO THE EXISTING SEWER.
 - ALL WORKS TO EXISTING SEWER WILL REQUIRE WRITTEN APPROVAL FROM THE STATUTORY UNDERGRADER PRIOR TO COMMENCEMENT OF WORKS.
 - ALL INTERNAL MANHOLES/CHAMBERS SHOULD BE FITTED WITH DOUBLE SEALED & LOCKABLE COVERS.

- CDM NOTES:
- THE ATTENTION OF THE CLIENT AND THE PRINCIPAL CONTRACTOR IS DRAWN TO THE FOLLOWING POTENTIAL RISKS IN CONJUNCTION WITH THE PROPOSED ON-SITE AND OFF-SITE WORKS AS DESIGNED FOR THIS PROJECT:
 - WORKS IN THE VICINITY OF LIVE SERVICES WILL BE NECESSARY AND THE ADVICE OF ALL STATUTORY SERVICE COMPANIES MUST BE SOUGHT BEFORE ANY WORKS COMMENCE.
 - WORKS WITHIN AND ABUTTING THE EXISTING HIGHWAY WILL ENTAIL TRAFFIC HAZARDS AND ALL APPROPRIATE SAFETY MEASURES INCLUDING BARRIERS, SIGNS AND LIGHTING MUST BE UNDERTAKEN TO THE APPROVAL OF THE LOCAL AUTHORITY, THE HIGHWAY AUTHORITY AND THE POLICE.
 - HAZARDOUS MATERIALS INCLUDING CEMENT AND BITUMINOUS MATERIALS ARE SPECIFIED AND THE MANUFACTURER'S ADVICE ON SAFE HANDLING PROCEDURES MUST BE OBTAINED AND MADE CLEAR TO ALL OPERATIVES.
 - THE CONTRACTOR WILL BE RESPONSIBLE FOR LOCATING ALL EXISTING SERVICES WITHIN THE VICINITY OF THE WORKS AND ENSURE THESE ARE PROTECTED THROUGHOUT THE DURATION OF THE WORKS. ALL UTILITY PLANT SHOULD BE CLEARLY MARKED ON THE GROUND PRIOR TO COMMENCEMENT OF THE WORKS.
 - THE CONTRACTOR MUST ENSURE ALL WORKING AREAS ARE FULLY SECURE.

DO NOT SCALE FROM THIS DRAWING

- NOTES:
- WHERE PROPOSED WORKS MAY REQUIRE THE ABANDONMENT OF ANY PREVIOUS APPROPRIATE CHECKS SHOULD BE UNDERTAKEN TO ENSURE THAT THERE ARE NO OTHER PROPERTIES CONNECTED TO THAT RUN.
 - ALL WORKS AND CONNECTIONS TO THE PUBLIC SEWERS TO BE CONSTRUCTED TO THE ADOPTABLE STANDARDS SPECIFIED IN SEWERS FOR ADOPTION.
 - ALL PRIVATE DRAINAGE IS TO COMPLY AND BE LAID IN ACCORDANCE WITH CURRENT PART 4 OF BUILDING REGULATIONS BS 8301 AND BS 6865.
 - POSITION & INVERT LEVELS OF ALL EXISTING MANHOLES, SEWERS AND LATERALS TO BE CONFIRMED PRIOR TO CONSTRUCTION & ANY DISCREPANCIES REPORTED TO THE ENGINEER.
 - ALL DRAIN AND SEWER PIPES ARE TO BE LAID SOFFIT TO SOFFIT, UNLESS SHOWN OTHERWISE (SEE ALSO MANHOLE SCHEDULE DRAWINGS).
 - ALL PLOT/PRIVATE DRAINAGE TO BE 100mm Ø UNLESS SHOWN OTHERWISE, LAID IN ACCORDANCE WITH BS 8301.
 - ALL MATERIALS SHALL COMPLY TO THE BS KITE MARK ACCORDINGLY.
 - COVER AND FRAMES TO MANHOLES/INSPECTION CHAMBERS TO COMPLY WITH BS EN124. REFER TO DRAINAGE CONSTRUCTION DETAILS DRAWING.
 - WHERE FINISHED GROUND LEVELS FALL TOWARDS BUILDING, AN OPEN GULLY IS TO BE PROVIDED AT THE FOOT OF ALL RAINWATER PIPES. ALL RAINWATER PIPES TO HAVE ROOFING ACCESS.
 - WHERE A DRAIN RUN PASSES THROUGH A WALL OR FOUNDATION IT IS NECESSARY TO:
 - FORM AN OPENING USING A CONCRETE LINTEL WITH AT LEAST 50mm CLEARANCE AROUND THE PIPE AND THE OPENINGS MASKED WITH RIGID SHEET MATERIAL TO PREVENT ENTRY OF FILL OR VERMIN, OR:
 - BUILD IN A LENGTH OF PIPE WITH ITS JOINTS AS CLOSE AS POSSIBLE TO THE WALL FACES (150mm MAXIMUM) AND CONNECTED ON EACH SIDE TO 600mm LONG ROCKER PIPES WITH FLEXIBLE JOINTS.

CONSTRUCTION

Rev	Date	Revision Description	Drn/Crkg/Aspd
C2	21.05.21	ROAD GULLIES MOVED FROM PLOT DRAINAGE LAYOUT TO MAIN DRAINAGE LAYOUT	KFM/RF/AC
C1	29.04.21	MINOR LEVEL AMENDMENTS AND UPDATES IN LINE WITH CLIENT AND SOUTHERN WATER COMMENTS	CDU/RF/AC
T3	22.02.21	PLOTS 413-414 & 426-432 UPDATED SWALE 13 UPDATED	CDU/TH/AC
T2	22.01.20	UPDATED TO SOUTHERN WATER AND CLIENT COMMENTS	CDU/HJ/AC
T1	31.10.19	TENDER ISSUE	CDU/HJ/AC
P2	02.10.19	PRELIMINARY ISSUE	HJ/AC
P1	27.09.19	PRELIMINARY ISSUE	CDU/HJ/AC

FAIRHURST Client:
135 Park Street,
LONDON
SE1 9EA

REDROW
110 YEARS

Tel: 020 7828 8205
Fax: 084 4381 4412
Web: www.fairhurst.co.uk
Email: london@fairhurst.co.uk

Project Title:
HERNE BAY PHASE 3

Drawing Title:
**MAIN DRAINAGE LAYOUT
SHEET 2 OF 3**

Scale @ A1	Project Number	Purpose of Issue	Status
1:250	133359	CONSTRUCTION	C
Drawn	Checked	Approved	
CDU	HJ	AC	
Drawn Date	Checked Date	Approved Date	
18/09/19	18/09/19	18/09/19	
Drawing Number	Rev		
133359-FAH-ZZ-00-DR-D-0502	C2		

PRIVATE DRAINAGE CONNECTIONS ARE NOT SHOWN.

THIS DRAWING SHOULD BE READ IN CONJUNCTION WITH FAIRHURST DRAWING NO. 133359-FAH-ZZ-00-DR-D-0515 HIGHWAY LONG SECTION & FAIRHURST DRAWING NO. 133359-FAH-ZZ-00-DR-D-0504 - 133359-FAH-ZZ-00-DR-D-0506 PLOT DRAINAGE LAYOUTS

LATERALS AND PRIVATE DRAINAGE CONNECTIONS ARE NOT SHOWN.

ALL DRAINAGE WORKS TO BE OFFERED FOR ADOPTION SHALL COMPLY WITH THE REQUIREMENTS OF SEWERS FOR ADOPTION 6TH EDITION AND ARE SUBJECT TO APPROVAL OF SOUTHERN WATER.

0m 5m 10m 15m 20m 25m
PLOT SCALE = 1:250

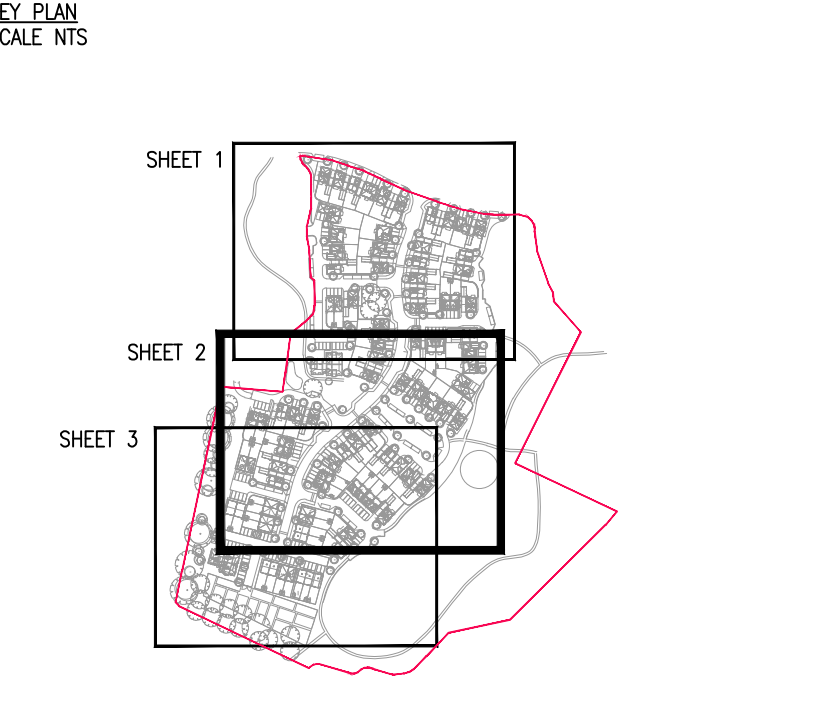

CONTINUATION ON SHEET
133359-FAH-ZZ-00-DR-D-0503