

- NOTES:
- THIS DRAWING TO BE READ IN CONJUNCTION WITH ALL OTHER RELEVANT ENGINEERS AND ARCHITECTS DRAWINGS AND SPECIFICATIONS.
  - ALL FOUL WATER PIPES FROM BELOW BUILDING SLABS TO BE NO SHALLOWER THAN 1:40.
  - ALL FOUL WATER PIPES TO BE 100Ø UNLESS OTHERWISE STATED.
  - ALL SURFACE WATER PIPES TO BE 150Ø UNLESS OTHERWISE STATED.
  - WHERE POSSIBLE, INSPECTION CHAMBERS IN GARDENS HAVE BEEN LOCATED 5m FROM BUILDINGS TO ACCOMMODATE FUTURE CONSERVATORIES.
  - DRAINAGE IS IN ACCORDANCE WITH SIA 6<sup>TH</sup> EDITION.
  - INVERT LEVELS OF EXISTING DRAINAGE AT PROPOSED OUTFALL TO BE VERIFIED ON SITE BY CONTRACTOR PRIOR TO CONSTRUCTION OF ANY DRAINAGE. THIS INFORMATION IS THEN TO BE GIVEN TO THE ENGINEER SO THAT ADJUSTMENTS TO THE DETAILED DESIGN CAN BE COMPLETED.
  - PUBLIC SEWER INFORMATION, AND STATUTORY SERVICE INFORMATION IF SHOWN IS BASED ON INFORMATION PROVIDED BY OR INTERPOLATED FROM PUBLIC SEWER AUTHORITY AND SERVICE PROVIDERS RECORDS. ALL INFORMATION RELATING TO SEWERS AND SERVICES TO BE VERIFIED ON SITE BY CONTRACTOR AND ENGINEER INFORMED IF INFORMATION DIFFERS FROM THAT SHOWN.
  - EXISTING LEVELS TAKEN FROM TOPOGRAPHIC SURVEY, TO BE CHECKED ON SITE AND ANY DISCREPANCIES REPORTED TO THE ENGINEER PRIOR TO CONSTRUCTION OF TIE IN BETWEEN EXISTING AND PROPOSED HIGHWAY.
  - APPROVAL FROM THE ENVIRONMENT AGENCY IS REQUIRED BEFORE THE OUTFALL RUN TO THE HEADWALL CAN BE CONSTRUCTED.
  - SECTION 106 AGREEMENT TO BE FINALISED BEFORE THE FOUL WATER SYSTEM CAN BE CONNECTED TO THE OUTFALL.

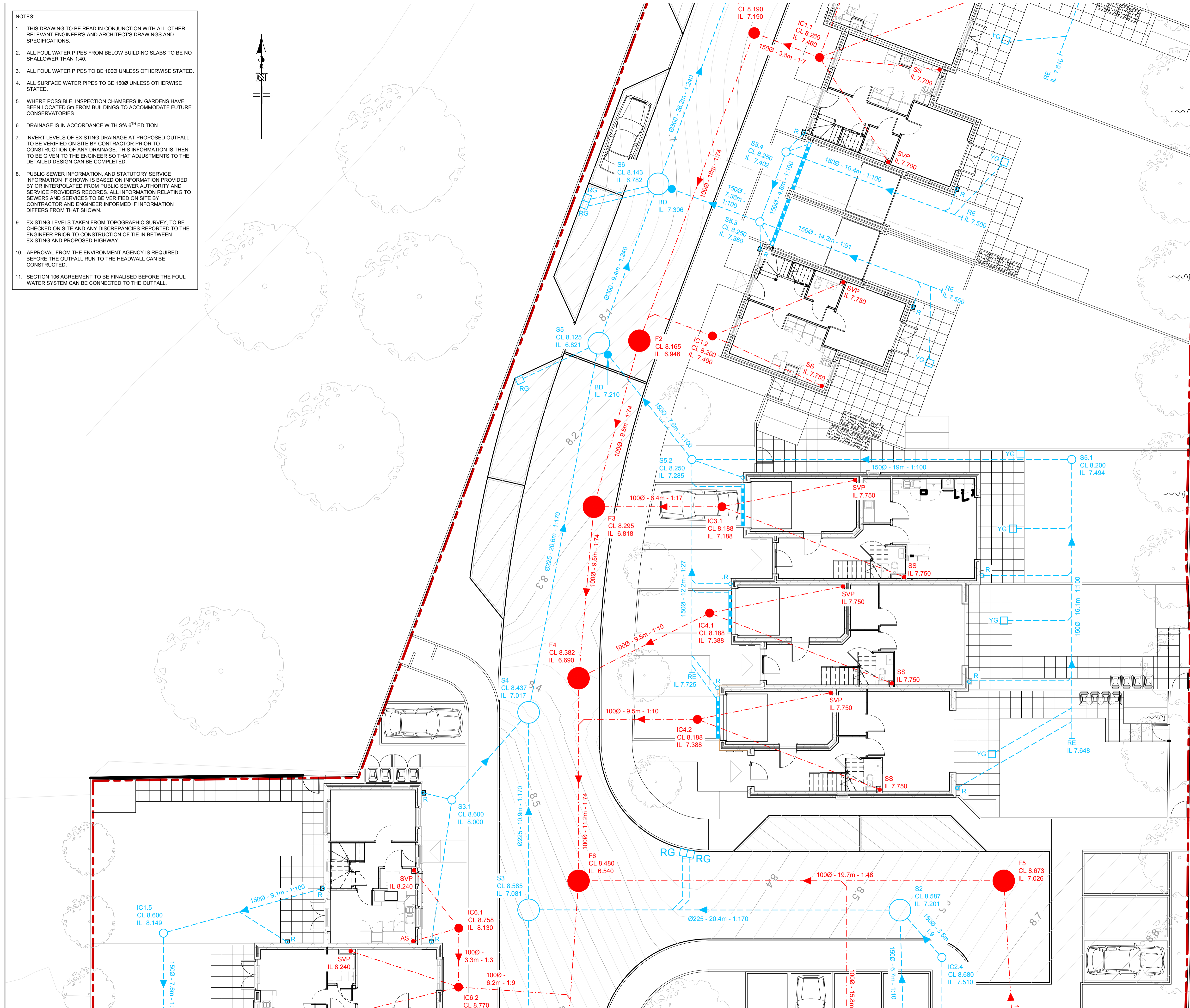
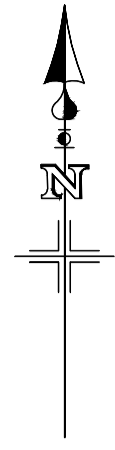

Do not scale from this drawing.

**SAFETY HEALTH AND ENVIRONMENTAL INFORMATION**

IN ADDITION TO THE HAZARD/RISKS NORMALLY ASSOCIATED WITH THE TYPES OF WORK DETAILED ON THIS DRAWING, NOTE THE FOLLOWING RISKS AND INFORMATION.

RISKS LISTED HERE ARE NOT EXHAUSTIVE. REFER TO DESIGN ASSESSMENT FORM NO.

CONSTRUCTION

DEMOLITION

FOR INFORMATION RELATING TO USE, CLEANING AND MAINTENANCE SEE THE HEALTH AND SAFETY FILE

IT IS ASSUMED THAT ALL WORKS WILL BE CARRIED OUT BY A COMPETENT CONTRACTOR WORKING, WHERE APPROPRIATE, TO AN APPROVED METHOD STATEMENT.

**KEY:**

**GENERAL**

- SITE BOUNDARY

**PUBLIC DRAINAGE**

- S278 SURFACE WATER DRAIN
- EXISTING SURFACE WATER DRAIN
- EXISTING SURFACE WATER CHAMBER
- EXISTING SURFACE WATER GULLY

**PRIVATE DRAINAGE**

- SURFACE WATER DRAIN
- SURFACE WATER CHAMBER
- HYDROBRAKE CHAMBER
- RAIN WATER DOWN PIPE
- RODDING EYE
- YARD GULLY, 100Ø OUTLET
- ROAD GULLY, 150Ø OUTLET
- CHANNEL DRAIN AND SUMP/GULLY UNIT
- BELOW GROUND GEOLIGHT SURFACE WATER ATTENUATION STORAGE SYSTEM BY SDS (TEL: 01934 751 303)

**FOUL DRAINAGE**

- FOUL WATER DRAIN. (pipe dia. & gradient)
- FOUL WATER CHAMBER
- ASSUMED STACK POSITION. ARCHITECT TO CONFIRM.
- STUB STACK
- SOIL AND VENT PIPE
- FOUL WATER SEWER. (pipe dia. & gradient)
- FOUL WATER MANHOLE

**FOR APPROVAL**

P03	14/11/19	LAYOUT REVISED FOR PLANNING RESUBMISSION.	TH	DAP	X
P02	31/10/19	PRELIMINARY ISSUE	TH	SJO	X
P01	10/19	PRELIMINARY ISSUE	TH	SJO	X
Rev.	Date	Description	Drwn	Chkd	Appd.

**FAIRHURST**

160 LONDON ROAD  
SEVENOAKS  
TN13 2JA

Tel: 01732 460 142  
Fax: 01732 459 249

Client:  
**COOMBS**

Project Title:  
**KINGSMEAD - CANTERBURY  
KENT - CT2 7LN**

Drawing Title:  
**PROPOSED DRAINAGE  
SHEET 2 OF 3**

Scale at A1: 1:100	Status: APPROVAL
Drawn: TH	Checked: SJO
Date: OCT '19	Date: OCT '19
Approved: -	Date: -
Drawing No.: <b>130084_C02</b>	Revision: <b>P03</b>