

NOTES

1. THIS DRAWING IS TO BE READ IN CONJUNCTION WITH ALL RELEVANT ENGINEERS, ARCHITECTS AND SPECIALISTS DRAWINGS AND THE SPECIFICATION.
2. ALL WORK IS TO BE CARRIED OUT IN ACCORDANCE WITH THE RELEVANT BRITISH STANDARDS, EUROPEAN NORMS, CODES OF PRACTICE AND BUILDING PRACTICE.
3. ALL DIMENSIONS ARE TO BE CHECKED BY THE CONTRACTOR PRIOR TO STARTING THE WORKS ON SITE. ANY DISCREPANCIES ARE TO BE REPORTED TO THE ENGINEER IMMEDIATELY.
4. FOR CIVIL & STRUCTURAL HEALTH & SAFETY HAZARDS PLEASE REFER TO DESIGNERS RISK ASSESSMENTS.
5. IF YOU DO NOT UNDERSTAND FULLY ANY OF THE DETAILS SHOWN ON THIS DRAWING CONTACT THE ENGINEER FOR CLARIFICATION.
6. BURED CONCRETE SULPHATE CLASS AS PER SITE INVESTIGATION REPORT.

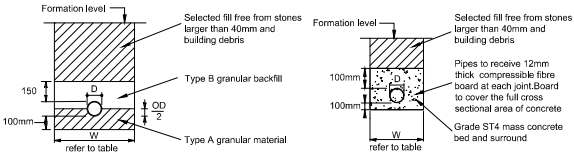

**TYPE 1 (CLAY PIPE)
CLASS B**

Location: Pedestrian areas up to 5.0m depth, Vehicle areas 0.6m - 5.0m

**TYPE 2 (CLAY PIPES)
CLASS X**

Location: Vehicle areas - up to 0.6m

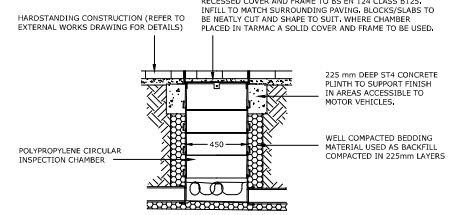

POLYPROPYLENE CIRCULAR INSPECTION CHAMBER (SCALE 1:20)

LOCATED WITHIN HARD PAVED/SURFACED AREAS FOR DEPTHS TO INVERT NOT GREATER THAN 1200mm

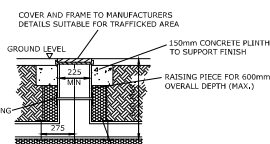

ACCESS CHAMBER (SCALE 1:20)

FOR COVERS SITED IN DRIVEWAYS, PAVED AREAS AND LANDSCAPED AREAS WHICH MAY BE OVERRUN BY MAINTENANCE VEHICLES.

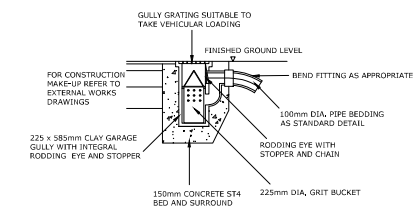

TRAPPED YARD GULLY TO DRIVES, FOOTPATHS & BINSTORE (SCALE 1:20)

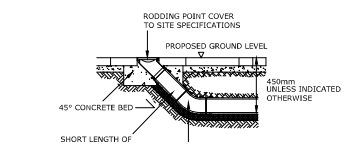

RODDING EYE DETAIL (SCALE 1:20)

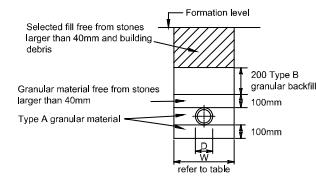

**TYPE 3 (UPVC PIPES)
CLASS S1**

Location: Pedestrian areas, 0.6m - 7.0m Vehicle areas, 0.9m - 7.0m Under buildings

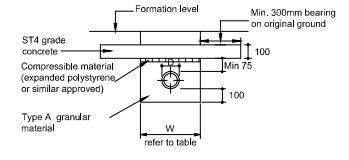

TYPE 4 (UPVC PIPES)

Location: Pedestrian areas up to 0.6m, private vehicle parking and areas subject to construction traffic up to 0.9m. When laid in landscape areas subject to no loading (incl. construction traffic) ST4 concrete can be omitted.

1. THIS DRAWING IS TO BE READ IN CONJUNCTION WITH ALL RELEVANT ENGINEER'S, ARCHITECT'S AND SPECIALIST'S DRAWINGS AND THE SPECIFICATION.
2. DO NOT SCALE FROM THIS DRAWING MANUALLY OR ELECTRONICALLY. WRITTEN PERMISSION MUST BE OBTAINED FROM MLM PRIOR TO SCALING ELECTRONICALLY OR USING THIS ELECTRONIC FILE.
3. TYPE A TO BE 10MM SINGLE SIZED AGGREGATE TO BS EN 1610 ANNEX B TABLE B15 FOR 1000 PIPES AND 14MM FOR 1500
4. TYPE B TO BE UNIFORM READILY COMPACTABLE MATERIAL FREE FROM ANY TREE ROOTS, VEGETATION MATTER, BUILDING DEBRIS, FROZEN SOIL, CLAY LUMPS RETAINED ON A 100MM SIEVE OR STONES RETAINED ON A 40MM SIEVE.
5. MINIMUM TRENCH WIDTHS FOR VARIOUS SIZE PIPES;

Ø	100	150	225	300	375
W	450	600	700	800	1100
6. WHERE A FOUNDATION PASSES CLOSE TO A SEWER OR DRAIN TRENCH OR TRIAL PIT THE FOUNDATION DEPTH IS TO BE SUCH THAT ITS UNDERSIDE IS BELOW A LINE PROJECTED UP AT 45° FROM THE NEAREST BOTTOM CORNER OF THE DRAIN TRENCH, SEWER TRENCH OR TRIAL PIT OR CONCRETE BACKFILL TRENCHES USED AS DETAILED
7. ANY SOFT SPOT FOUND IN TRENCH LINE TO BE REPORTED TO SITE STAFF PRIOR TO PLACING OF PIPE BEDDING.
8. JOINT FILLER TO CONCRETE PIPE SURROUND SHALL CONSIST OF BITUMEN IMPREGNATED INSULATING BOARD TO BS 1142 PART 3. THICKNESS OF BOARD 12MM.
9. ALL PIPEWORK SHALL BE CONSTRUCTED FROM 'SUPER STRENGTH' VITRIFIED CLAY TO BS 65, BS EN 295 OR UPVC TO BS EN 1401
10. MANHOLE COVERS IN PRIVATE AREAS ACCESSIBLE TO MOTOR VEHICLES TO BE CLASS B125 AND IN PRIVATE AREAS INACCESSIBLE TO MOTOR VEHICLES TO BE CLASS A15.
11. PRECAST CONCRETE PIPES AND CHAMBERS TO BE TO BS 5911.

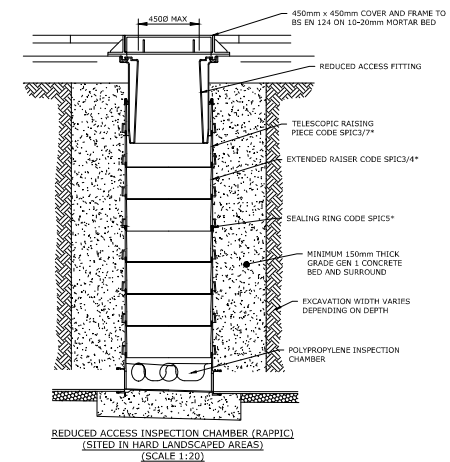
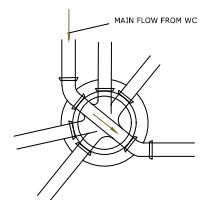

REDUCED ACCESS INSPECTION CHAMBER (RAPPIC) (SITED IN HARD LANDSCAPED AREAS) (SCALE 1:20)

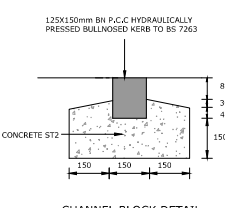

CHANNEL BLOCK DETAIL

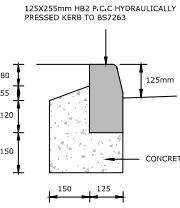

FULL HEIGHT KERB DETAIL

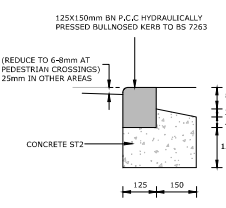

KERB DETAIL (BN) (BN25)

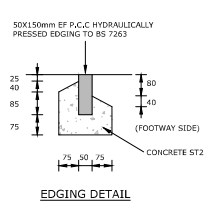

EDGING DETAIL

NOTE:
Dropped kerbs at paths etc to be formed by angling BN25 kerb to a 6-8mm upstand. End of kerbs to be chamfered to suit to form clean gap free joints. Colour matched mortar to be used at joints if necessary.

P02	02.08.2022	Kerb detail amended to suit design	TC	TC	TC
P01	06.07.2022	FIRST ISSUE	TC	TC	TC
Rev	Date	Amendment Details	D'n	Chk	App

This drawing should not be relied on or used in circumstances other than those for which it was originally produced and for which Sweco UK Limited was commissioned. Sweco UK Limited accepts no responsibility for this drawing to any party other than the person to whom it was commissioned. Any party which breaches the provisions of this disclaimer shall indemnify Sweco UK Limited for all loss or damage arising therefrom. COPYRIGHT © Sweco 2021

Sweco
Connect 38
1 Dover Place
Ashford, Kent
TN23 1FB
Tel: +44 (0)1233 610 530
Web: www.sweco.co.uk



Client
Aspire Designer Homes

Project Title
Vulcan Close

Drawing Title
Construction Details Sheet 1

Purpose Of Issue PRELIMINARY					
Status	Initial Status OR WIP				
Drawn	TC	TC	Checked	-	Approved
Sheet Size	A1	N/A	SWECO Ref	-	Revision
Drawing Number	65203468-SWE-ZZ-00-DR-C-0005				