

**GENERAL NOTES:**

1. THIS DRAWING IS TO BE READ IN CONJUNCTION WITH ALL OTHER RELEVANT DOCUMENTATION.
2. DO NOT SCALE FROM THIS DRAWING.
3. ALL DIMENSIONS ARE IN METRES UNLESS SPECIFIED OTHERWISE.
4. EXISTING GROUND INFORMATION IS BASED ON DRAWINGS '1:2008' TOPOGRAPHIC SURVEY BY RL SURVEYS
5. PROPOSALS ARE BASED ON CLAGUE DRAWINGS 22933\_# RECEIVED 25.04.2018

**DRAINAGE NOTES:**

1. ALL ADOPTED DRAINAGE NETWORKS TO COMPLY WITH SEWERS FOR ADOPTION 7TH EDITION GULLIES AND GULLY LEADS TO MEET SHW AND ADDENDUM BY HCC. ALL OTHER DESIGN MATERIALS AND WORKMANSHIP TO COMPLY WITH BUILDING REGULATIONS.
2. CONTRACTOR TO CONFIRM LEVEL OF ALL EXISTING SEWER CONNECTIONS 5 WORKING DAYS PRIOR TO CONNECTION AND TO NOTIFY THE DESIGNER OF ANY DISCREPANCIES.
3. CONCRETE SURROUND AND LINTELS TO BE USED WHERE PIPES PASS THROUGH WALLS AND OTHER STRUCTURES.
4. THE CONTRACTOR IS TO ENSURE ACCESS COVERS DO NOT STRADDLE KERBS OR PAVING JOINTS.
5. CONTRACTOR SHALL ALLOW FOR ADJUSTMENT TO BENCHING IN EXISTING MANHOLES WHERE NEW LATERAL CONNECTIONS ARE INSTALLED.
6. ALL DRAINAGE NETWORKS SHOULD BE MAINTAINED REGULARLY BY A COMPETENT PERSON(S) TO ENSURE EFFECTIVE ONGOING OPERATION.
7. LANDSCAPE DESIGN BY OTHERS. LANDSCAPE TO BE ADJUSTED WHERE CONFLICTED WITH DRAINAGE LAYOUT.
8. CONTRACTOR TO ALLOW FOR ADJUSTMENTS TO EXISTING MANHOLE ON PUBLIC SEWER CONNECTION (I.E. AT LOCATION OF S106 CONNECTION).

**DESIGN CRITERIA (PRIVATE):**

1. TOP OF COVER SLABS SHALL BE MIN 450 BELOW GROUND SURFACE OR CARRIAGEWAY LEVEL.
2. ALL PRIVATE SW PIPES SHALL BE 150 DIA LAD WITH MIN. 1:150 LONG FALL.
3. ALL PRIVATE FW PIPES SHALL BE 100 DIA LAD WITH MIN. 1:80 LONG FALL.
4. MINIMUM DEPTH OF COVER TO THE CROWN OF PIPES WITHOUT PROTECTION SHOULD BE AS FOLLOWS:
  - 0.3M IN GARDEN AND PATHWAYS WITHOUT VEHICLE ACCESS
  - 0.5M IN DOMESTIC DRIVES AND PARKING AREA WHERE HEIGHT RESTRICTIONS EXIST TO PREVENT VEHICLES IN EXCESS OF 7.5 TONNES
  - 0.5M IN DOMESTIC DRIVES AND PARKING AREAS WITH LIMITED ACCESS FOR VEHICLES IN EXCESS OF 7.5 TONNES
  - 1.2M IN ALL OTHER AREAS.
5. TYPE 4 MANHOLES (300mm DIA) TO BE USED UP TO A DEPTH OF 1m, WITH A MAXIMUM OF 4 NO. 100mm DIA CONNECTIONS.
6. TYPE 3 MANHOLES (600mm DIA) TO BE USED UP TO A DEPTH OF 3m, WITH A MAXIMUM OF 4 NO. 150mm DIA CONNECTIONS AND 2 NO. 100mm DIA CONNECTIONS.

**KEY**

- PROPOSED SURFACE WATER SEWER
- PROPOSED SURFACE WATER MANHOLE
- ▨ PROPOSED CHANNEL DRAIN
- PROPOSED GULLY WITH SILT TRAP
- ▩ PROPOSED CELLULAR STORAGE STRUCTURE REFER TO MANUFACTURERS DETAILS FOR INSTALLATION REQUIREMENTS
- PROPOSED RODDING EYE
- PROPOSED FOUL WATER SEWER
- PROPOSED FOUL WATER MANHOLE

Mark	Revision	Date	Drawn	Chkd	Appd

SCALING NOTE: Do not scale from this drawing. If in doubt, ask.  
 UTILITIES NOTE: The position of any existing public or private sewers, utilities, services, plant or apparatus shown on this drawing is believed to be correct, but no warranty to this is expressed or implied. The Contractor is therefore advised to undertake their own investigation where the presence of any existing sewers, services, plant or apparatus may affect the operations.

**DRAWING ISSUE STATUS INFORMATION**

**ESTUARY VIEW, WINTSTABLE DRAINAGE LAYOUT**

**Client**  
 GEORGE WILSON DEVELOPMENTS Ltd

**Date of 1st Issue** 05.07.18 **Designed** OP **Drawn** OP

**A1 Scale** 1:200 **Checked** RE **Approved**

**Drawing Number** 43922/2002/500/001 **Revision** -

**www.peterbrett.com**  
 Offices throughout the UK and Europe  
 © Peter Brett Associates LLP  
 ASHPROD  
 Tel: 01233 651 740

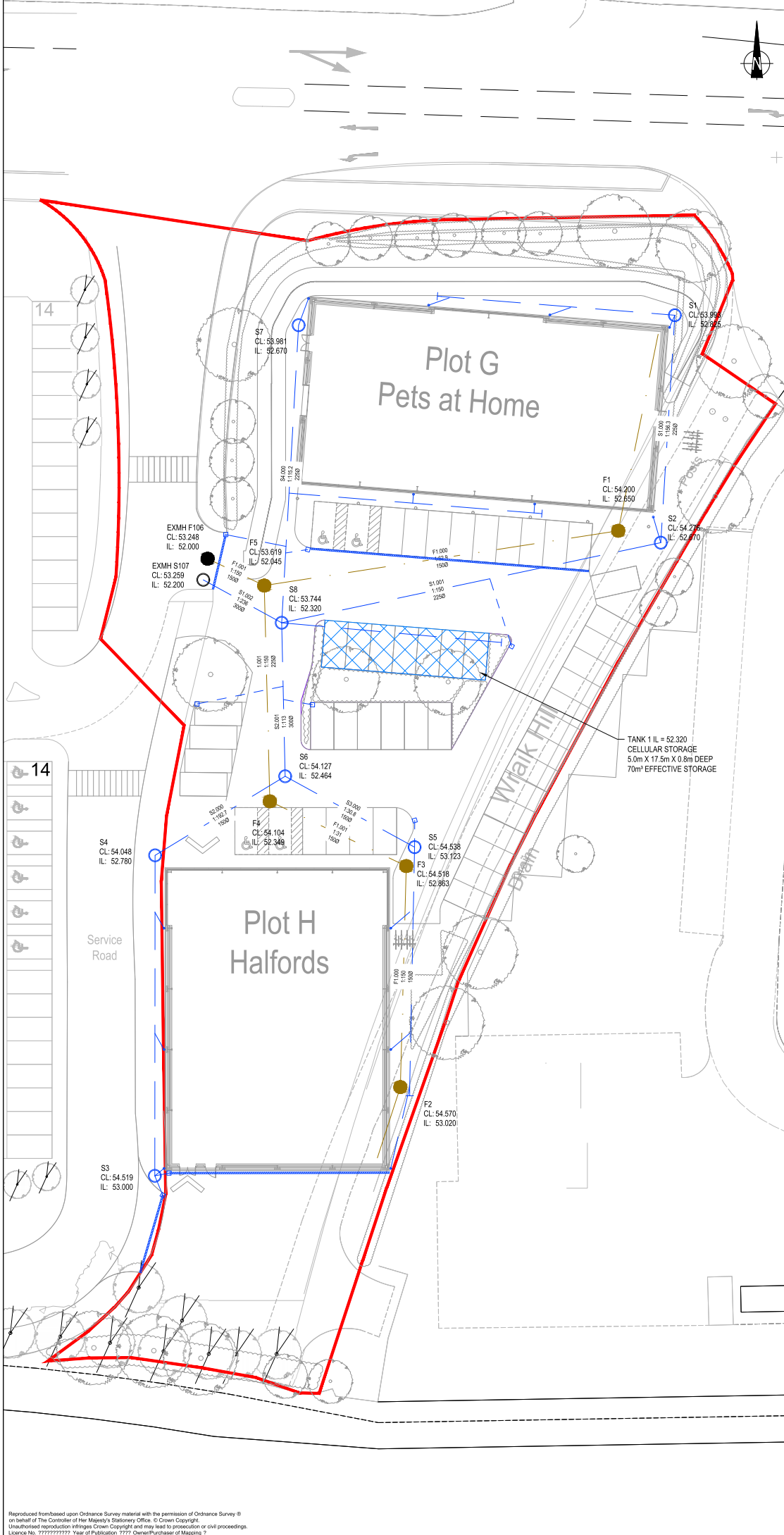

Reproduced from based upon Ordnance Survey material with the permission of Ordnance Survey © on behalf of The Controller of Her Majesty's Stationery Office. © Crown Copyright. Unauthorised reproduction infringes Crown Copyright and may lead to prosecution or civil proceedings. Licence No. 712272217. Year of Publication 1977. Owner/Purchaser of Mapping 7