

**Appendices**

**Appendix D – Vehicle Tracking**

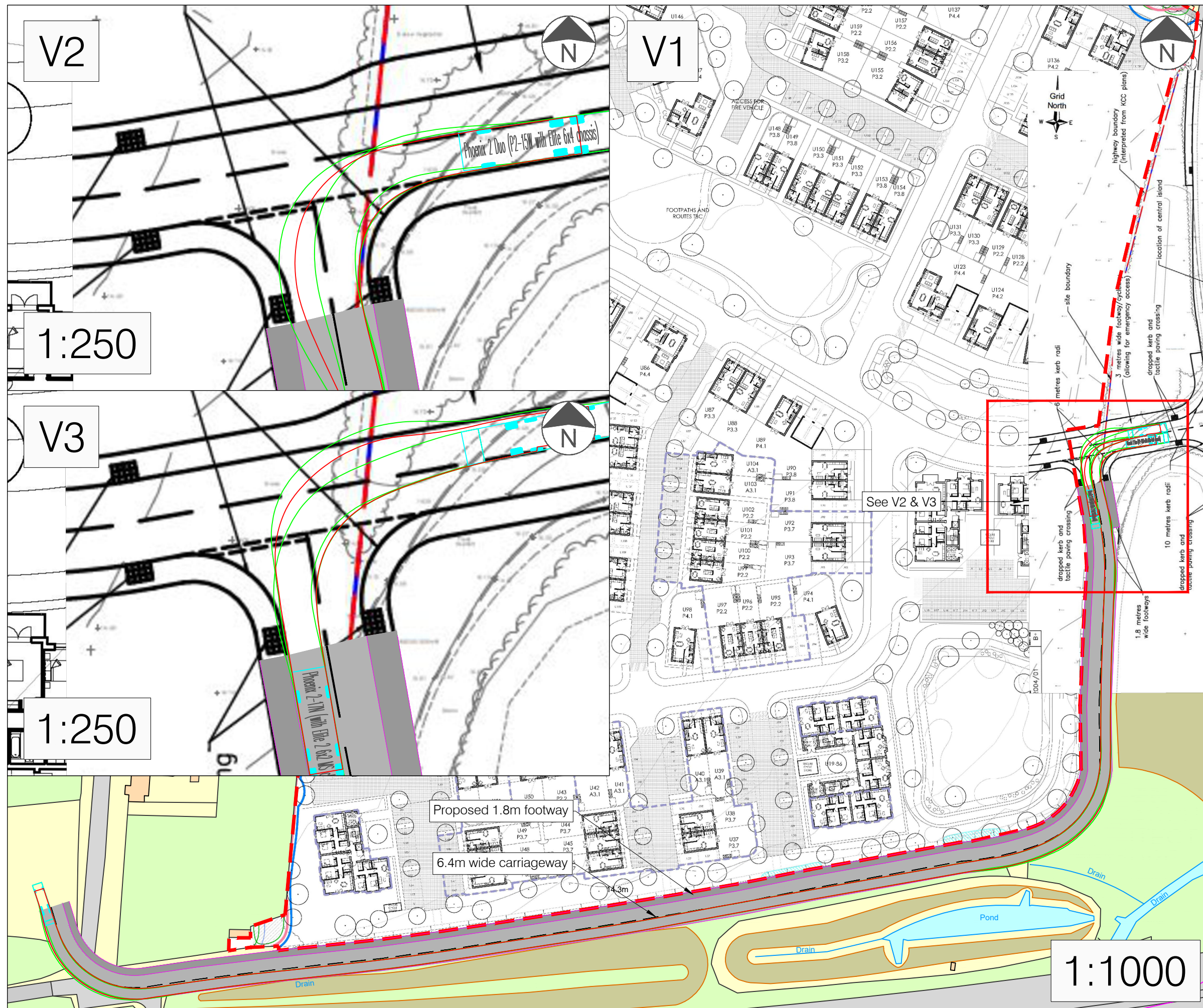



Phoenix 2-17N (with Elite 2 6x2 MS chassis)	
Overall Length	10.195m
Overall Width	2.230m
Overall Body Height	3.699m
Min Body Ground Clearance	0.251m
Track Width	2.200m
Lock to lock time	4.00s
Kerb to Kerb Turning Radius	10.300m

Rev	Date	Description	Drn	Chk	App
A	30/05/2024	INDICATIVE ROAD LAYOUT	RF	MV	SL

This drawing has been specifically prepared to meet the requirements of the named client and may contain design and innovative features which differ from conventional design standards.

**PROJECT CENTRE**

www.marstonholdings.co.uk/projectcentre

Client	shp				
Project	LAND AT ABBOTTSWOOD, HERNE BAY				
Drawing Title	REFUSE VEHICLE TRACKING				
Drawing Status	FOR DISCUSSION				
Drawn	Designed	Date	Scale	Size	
RF	RF	MAY 24	AS SHOWN	A3	
Drawing No.					Rev
1000010039-611-02-TRACKING					A