

GENERAL NOTES:

- DO NOT SCALE FROM THIS DRAWING.
- ALL DIMENSIONS ARE IN METRES UNLESS STATED OTHERWISE.
- DRAWING BASED ON TOPOGRAPHICAL SURVEY BY JC WHITE DATED APRIL '23 AND ORDNANCE SURVEY MAPPING INFORMATION PROVIDED BY CANTERBURY CITY COUNCIL.
- ALL WORKS TO BE UNDERTAKEN IN ACCORDANCE WITH THE SPECIFICATION FOR HIGHWAY WORKS (S.H.W) AND KENT COUNTY COUNCIL SPECIFICATION.
- THIS DRAWING IS TO BE READ IN CONJUNCTION WITH ALL OTHER RELEVANT DOCUMENTATION.
- FOR DETAILS REFER TO DRAWING NUMBER:
330610743-STN-HSC-D-DR-CH-201 SITE CLEARANCE
330610743-STN-HSC-D-DR-CH-501 DRAINAGE
330610743-STN-HGN-D-DR-CH-701 PAVEMENTS
330610743-STN-HFK-D-DR-CH-1101 KERBBING
330610743-STN-HSN-D-DR-CH-1201 SIGNAGE & ROAD MARKINGS
330610743-STN-HSL-D-DR-CH-1252 TRAFFIC SIGNALS
330610743-STN-HSL-D-DR-CH-1301 STREET LIGHTINGS
- FOR PAVING SECTIONS AA, BB, CC AND DD, REFER TO DRAWING 330610743-STN-HGN-D-DR-CH-001.
- BRASS STUDS TO BE INSTALLED TO THE FOOTWAY ALONG THE HIGHWAY BOUNDARY LINE BY THE MASONIC LODGE AND THE FORMER BARRETT'S REDEVELOPMENT SITE.

LEGEND:

- PROPOSED NEW SAWN FLAMED TEXTURED YORKSTONE PAVING 300mm x 600mm
- RE-USED YORKSTONE PAVING 300mm x 600mm
- PROPOSED GRANITE SETT PAVING SAWN & TUMBLED 200mm x 100mm x 100mm UNLESS SHOWN OTHERWISE
- RE-USED GRANITE SETT PAVING 200mm x 100mm x 100mm UNLESS STATED OTHERWISE ON THE DRAWING
- PROPOSED BLOCK PAVING
- PROPOSED BUFF RESIN BONDED SURFACING
- PROPOSED BUFF RESIN BONDED SURFACING FULL DEPTH RECONSTRUCTION 1m WIDE
- TREE PIT / RAIN GARDEN AREA SEE DETAIL 330610743-STN-HGN-D-DR-CH-001
- PROPOSED GRANITE CHANNEL LAID FLUSH WITH PAVING 300mm x 150mm
- PROPOSED GULLY - TO REPLACE EXISTING GULLY, CONNECTED TO EXISTING GULLY LEAD
- EXISTING STREET LIGHTING
- PROPOSED STREET LIGHTING
- PROPOSED BOLLARD / REMOVABLE BOLLARD
- EXISTING HIGHWAY BOUNDARY - BASED ON OS INFORMATION
- PROPOSED CCTV CAMERA LOCATION
- BUFF TACTILE PAVING
- RED TACTILE PAVING
- PROPOSED BENCH

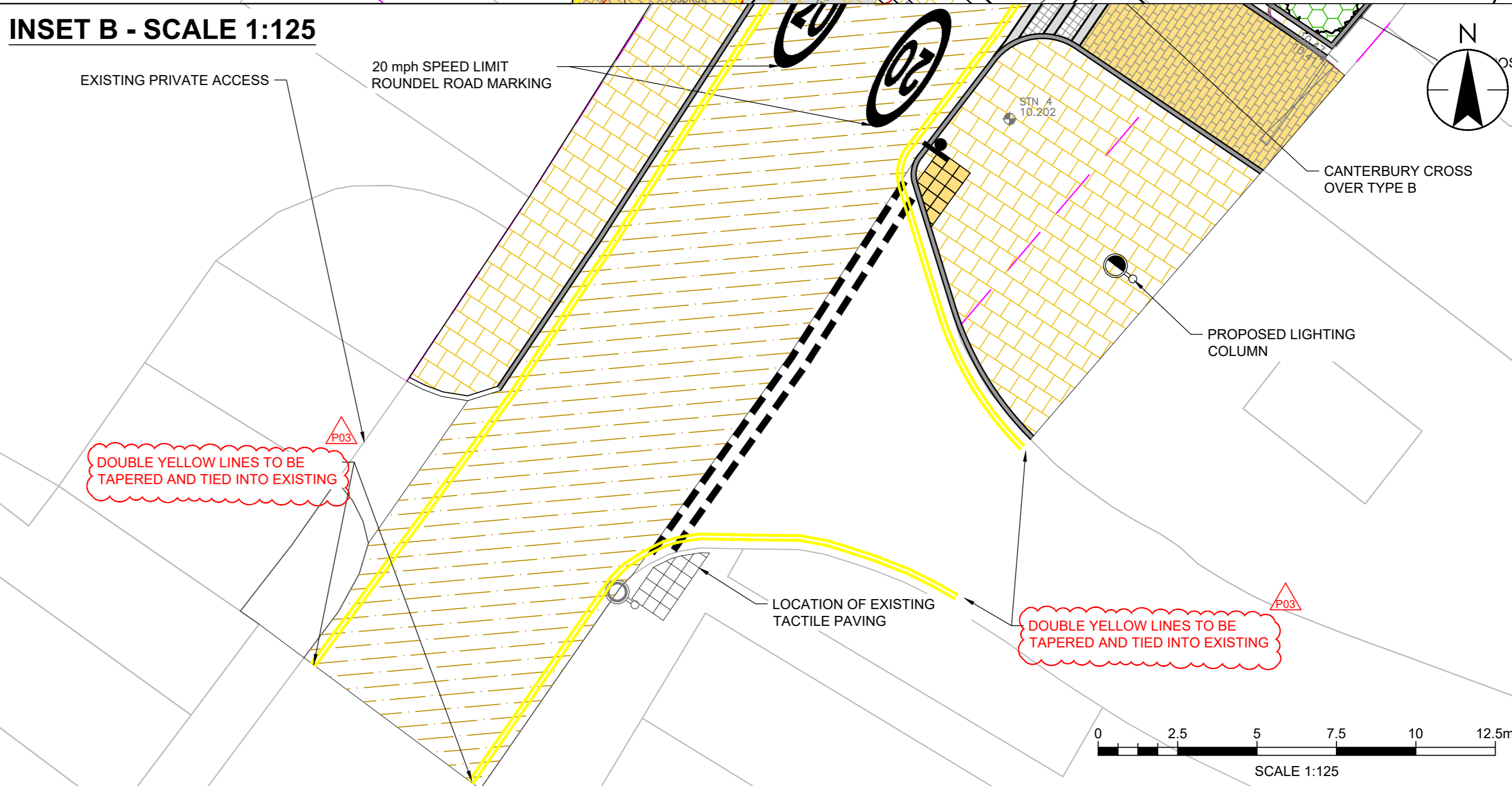
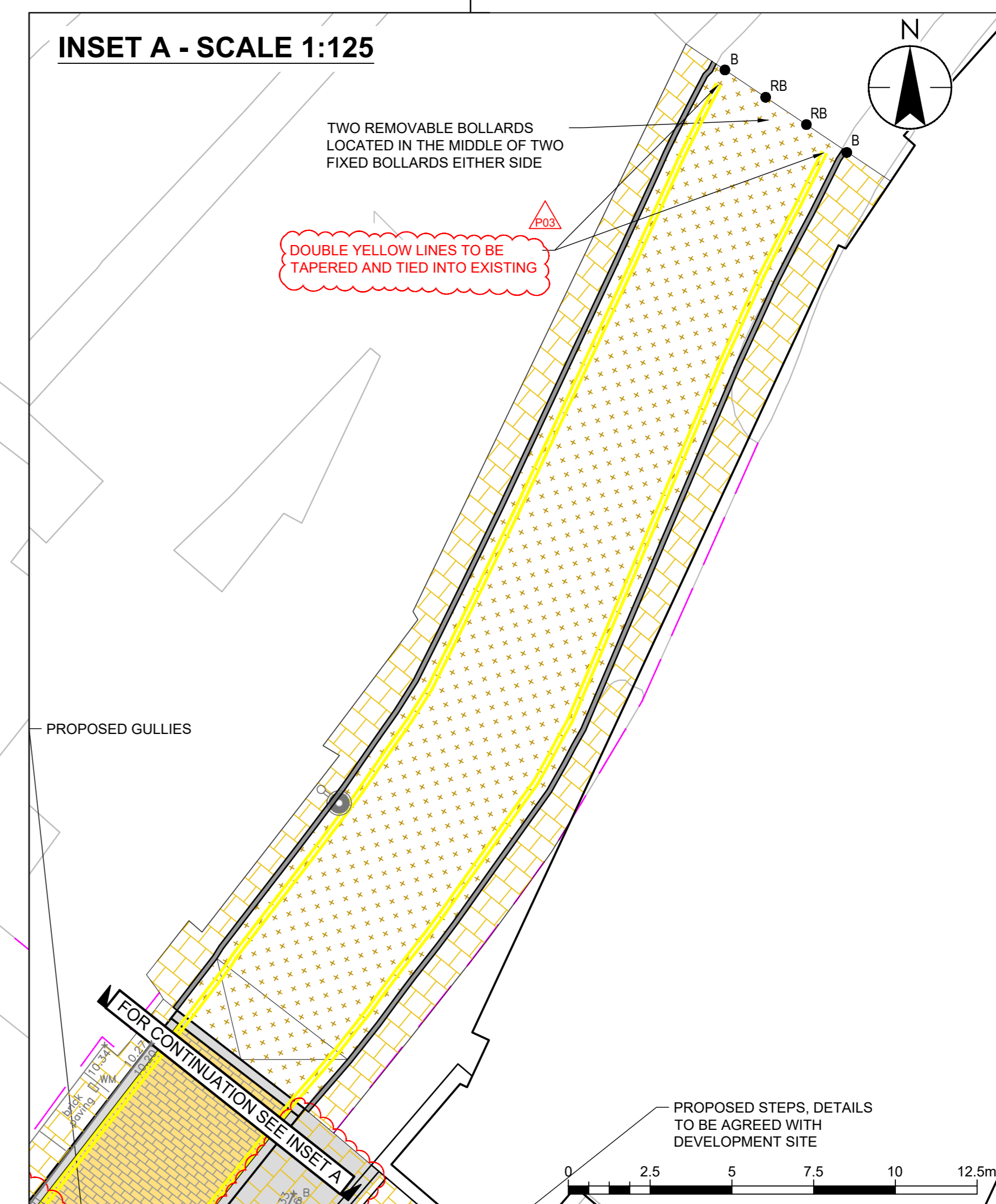
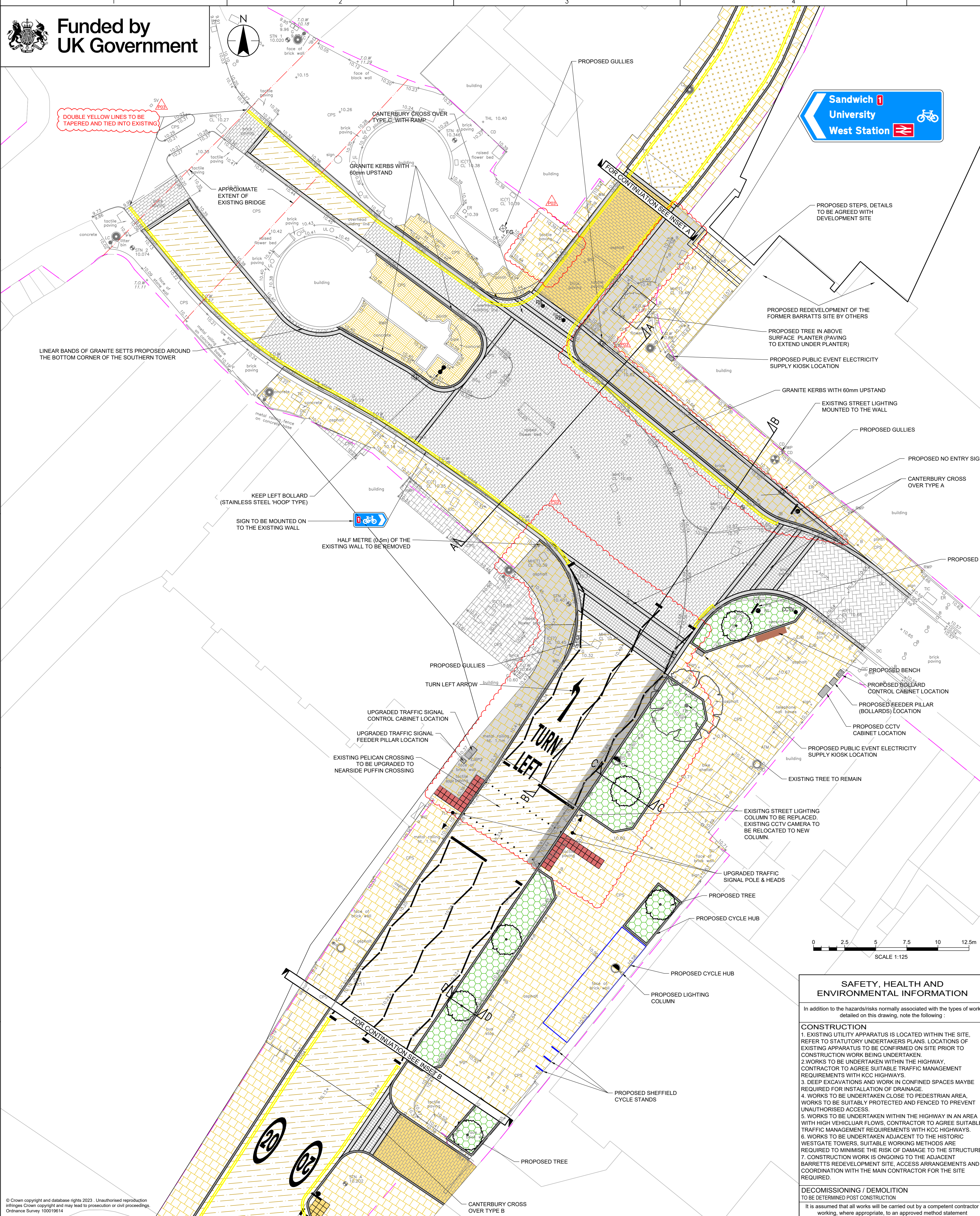

SAFETY, HEALTH AND ENVIRONMENTAL INFORMATION

In addition to the hazards/risks normally associated with the types of work detailed on this drawing, note the following:

CONSTRUCTION

- EXISTING UTILITY APPARATUS IS LOCATED WITHIN THE SITE. REFER TO STATUTORY UNDERTAKERS PLANS. LOCATIONS OF EXISTING APPARATUS TO BE CONFIRMED ON SITE PRIOR TO CONSTRUCTION WORK BEING UNDERTAKEN.
- WORKS TO BE UNDERTAKEN WITHIN THE HIGHWAY. CONTRACTOR TO AGREE SUITABLE TRAFFIC MANAGEMENT REQUIREMENTS WITH KCC HIGHWAYS.
- DEEP EXCAVATIONS AND WORK IN CONFINED SPACES MAYBE REQUIRED FOR INSTALLATION OF DRAINAGE.
- WORKS TO BE UNDERTAKEN CLOSE TO PEDESTRIAN AREA. WORKS TO BE SUITABLY PROTECTED AND FENCED TO PREVENT UNAUTHORISED ACCESS.
- WORKS TO BE UNDERTAKEN WITHIN THE HIGHWAY IN AN AREA WITH HIGH VEHICULAR FLOWS. CONTRACTOR TO AGREE SUITABLE TRAFFIC MANAGEMENT REQUIREMENTS WITH KCC HIGHWAYS.
- WORKS TO BE UNDERTAKEN ADJACENT TO THE HISTORIC WESTGATE TOWERS. SUITABLE WORKING METHODS ARE REQUIRED TO MINIMISE THE RISK OF DAMAGE TO THE STRUCTURE.
- CONSTRUCTION WORK IS ONGOING TO THE ADJACENT BARRETT'S REDEVELOPMENT SITE. ACCESS ARRANGEMENTS AND COORDINATION WITH THE MAIN CONTRACTOR FOR THE SITE REQUIRED.

DECOMMISSIONING / DEMOLITION

TO BE DETERMINED POST CONSTRUCTION

It is assumed that all works will be carried out by a competent contractor working, where appropriate, to an approved method statement.

Issue/Revision	By	App'd	Issue Date
P03 CROSSING REVISED	AF	AM	2024.09.10
P02 DRAWING UPDATES: DOUBLE YELLOW LINES AND ROAD MARKINGS CONSTRUCTION UPDATES WITH AREAS CLOUDED	CJ	AM	2024.08.11
P01 FIRST ISSUE	AGAL	AM	2024.06.04
Issued/Revision	By	App'd	YYYY.MM.DD
	CJ	CJ	2024.06.04
	Dwn	Dwn	YYYY.MM.DD

S3 - FOR REVIEW AND COMMENT

This document is suitable only for the purpose noted above. Use of this document for any other purpose is not permitted.

Client/Project Logo

Client/Project
CANTERBURY CITY COUNCIL

Title
WESTGATE SQUARE GENERAL ARRANGEMENT PLAN

Project No. 330610743
Revision P03
AD Scale 1:125
Drawing No. 330610743-STN-HGN-D-DR-CH-0101