

- Drawing Notes:**
- Drawings to be read in conjunction with all HTA hard and soft landscape information (including relevant drawings, specification and schedules), as well as all other consultants' information.
 - Within Scheduled Monuments and sites within the Area of Archaeological Importance, an archaeological watching brief will be required to monitor groundworks and for any trial piling, trial trenching.
 - Refer to Arboriculturalist's information for existing tree protection requirements, tree works and all works within Root Protection Areas (RPAs). All work within RPAs of existing retained trees to be undertaken under arboricultural supervision and to be carried out by hand such as digging and removal of existing hard landscape.
 - Refer to Civil Engineer's information for highways layouts, build-ups and loading requirements, drainage strategy and structural design information.
 - Detailed interpretation and lighting proposals are to be developed.
 - Contractors to make themselves aware of all services on site prior to commencement of work on site.
 - All dimensions in millimetres unless stated otherwise.
 - Contractor to verify and coordinate to existing conditions on site including positions of existing entrances, building features and adjacent land.
 - All dimensions to be verified on site by contractor/fabricators prior to start and to inform shop drawings. Any discrepancy between site dimensions and drawings to be brought to the attention of the Landscape Architect prior to fabrication / construction.
 - Shop drawings to be provided by fabricators for comment prior to fabrication.
 - Install all products to manufacturer's recommendations unless specified otherwise.
 - Setting out of paving where possible to full unit dimensions to minimise site cutting. No unit to be cut to less than one third of its original size.
 - All cutting of pavers and flags to be carried out using a diamond tipped saw.
 - All service runs to be buried to depth that allows for required landscape build ups above them.
 - All service access covers in hard landscape to be recessed and surfaced with material to match with adjacent hard surface.
 - All trees and plants to be set out on site with Landscape Architect in attendance prior to planting. Give sufficient notice.
- *Information provided by Civic Engineers and included on HTA's drawings.

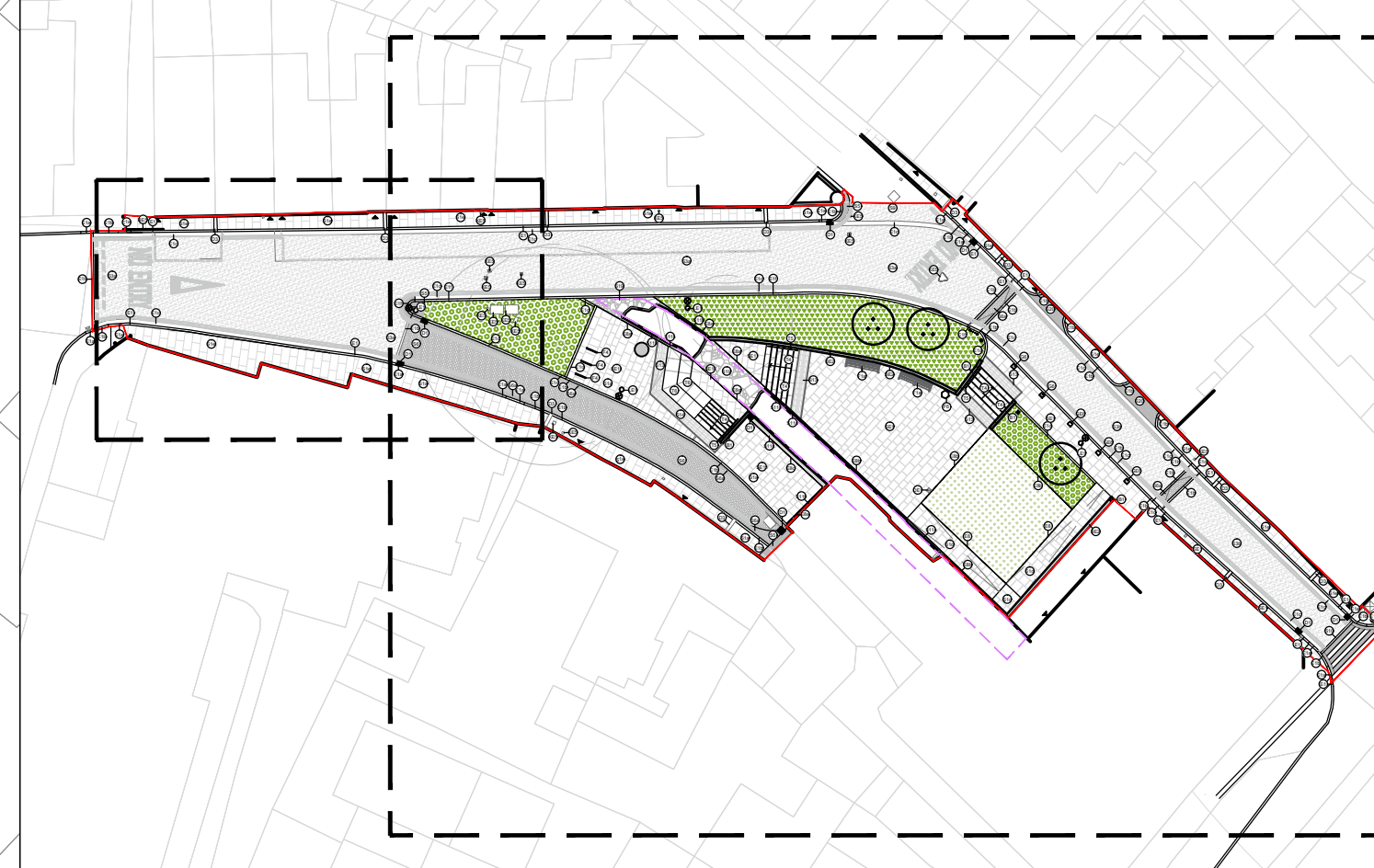

- LEGEND**
- GENERAL ARRANGEMENT**
- Site boundary
 - Scheduled Monument boundary
 - Existing tree and Root Protection Area (RPA)
 - Proposed tree
 - Ornamental perennial, bulb and shrub planting
 - Lawn
 - Access to building
- LEGEND**
- HARD LANDSCAPE**
- | DWG | NBS | Description |
|---|------------|--|
| EXISTING, TO BE RETAINED | | |
| KE5 | n.a. | Existing service cover to be retained |
| EXISTING, TO BE RETAINED AND REFURBISHED (R&R) | | |
| DE | n.a. | Existing gully drain |
| SE | n.a. | Existing Yorkstone slab paving to be retained |
| BE2 | F10/230-A | Existing brick wall to be retained and refurbished |
| SE11 | Q25/110-B | Existing natural stone paving retained and relaid |
| LE1 | Q50/300 | Existing historic 'Biggleston' light column retained and refurbished |
| GE5a | Q50/191 | Existing granite bollard retained and relocated |
| PROPOSED | | |
| F1a | Q50/225 | Timber and cast iron bench with backrest and armrests, 2.4m length |
| F4 | Q50/210 | Cycle stand |
| F6 | Q50/240 | Litter bin |
| S1a | Q25/310-A | Reclaimed Yorkstone slab paving to match existing, vehicular |
| S1d | Q25/310 | Reclaimed Yorkstone slab paving, reduced build up |
| S1e | Q25/310-B | Reclaimed Yorkstone slab paving, to Highway footway standard |
| S3a | Q23/200 | Resin Bonded gravel on new asphalt, level retained |
| S3b | Q23/200-B | Resin Bonded gravel on new asphalt, level raised |
| S5 | Q25/330 | Natural stone mix setts - Type A |
| S6 | Q25/340-A | Natural stone mix cobbles - Type B |
| S6a | Q25/340 | Natural stone mix cobbles - Type C |
| S9 | CIVIC Spec | Asphalt |
| S10 | n.a. | Canterbury crossing |
| S11a | Q23/160-A | Loose gravel infill on permeable mortar bedding along city wall |
| S11b | Q23/160-B | Mortar bound gravel infill along city wall |
| S11c | Q23/160-C | Loose gravel infill along city wall to Upper terrace |
| S13 | Q25/310-C | Yorkstone corduroy tactile hazard warning paving |
| S14 | Q25/310-D | Yorkstone corduroy tactile hazard warning paving - Vehicular |
| S19 | Q25/311 | Interpretative natural stone surface |
| S20 | Q25/330-A | Yorkstone setts paving |
| T4 | L37/315 | Yorkstone clad step |
| T5 | L37/150 | Handrail to steps |
| T6 | L37/315-A | Yorkstone clad seating units |
| E1 | Q10/121 | Granite kerb 150mm, upstand as existing |
| E1a | Q10/121 | Granite kerb 150mm, transition (dropped) |
| E1b | Q10/121-A | Granite kerb 150mm, flush |
| E1c | Q10/121-B | Granite kerb 300mm, flush |
| E1d | Q10/121-C | Granite kerb 150mm, 50mm upstand |
| E1f | Q10/121-D | Granite kerb 150mm, 150mm upstand |
| E8 | Q10/123 | Raised Corten edging, height varies |
| E8a | Q10/123-A | Corten Edging, 150mm height |
| E8b | Q10/123-B | 50mm upstand Corten edging, 170mm height |
| E8c | Q10/123-C | Flush Corten edging, 250mm height |
| B1 | F10/230 | Proposed brick wall to match existing |
| D3 | Q10/190 | Natural stone drainage channel |
| G5 | Q50/196 | Granite bollard to match existing |

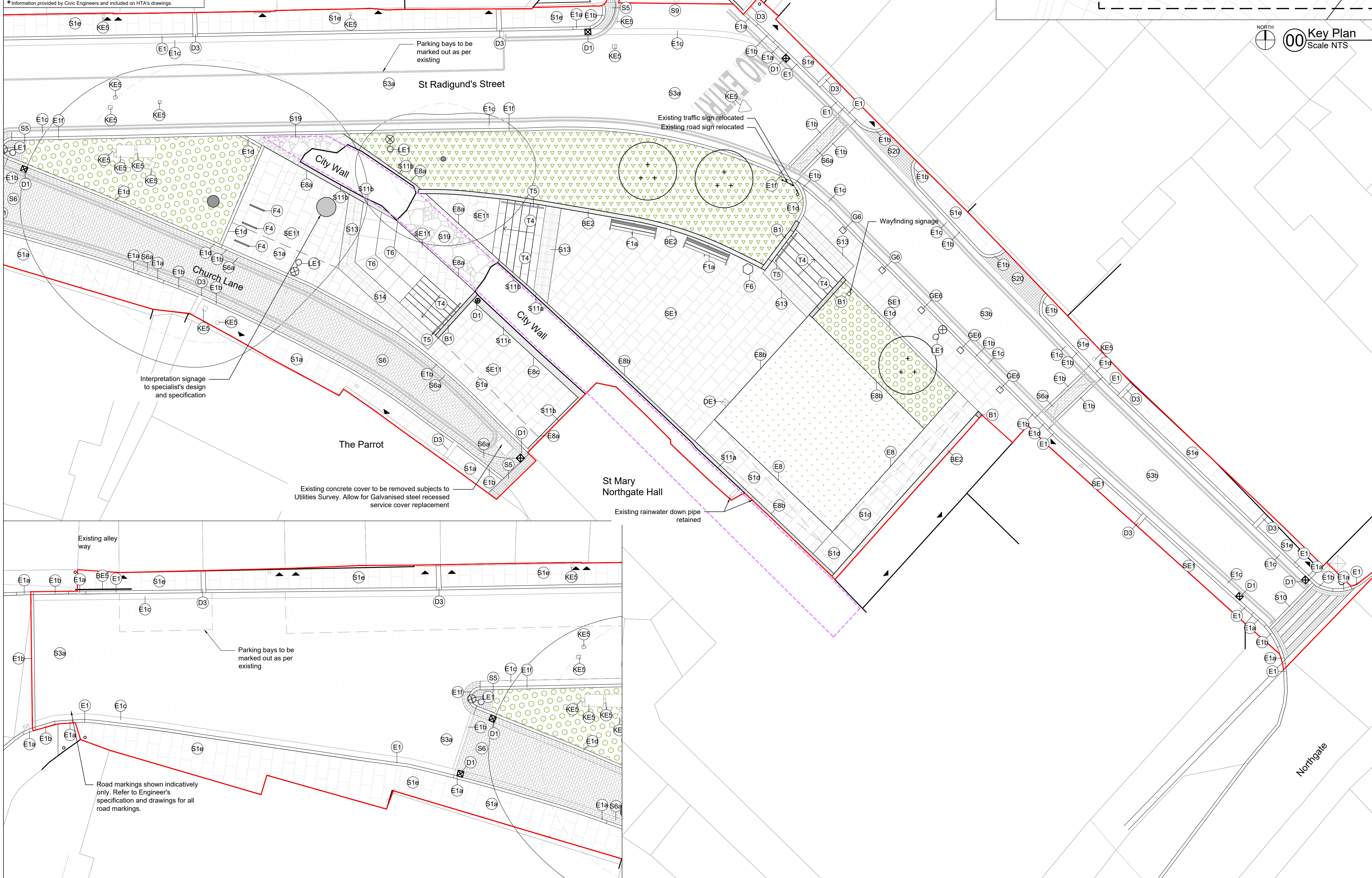

FOR TENDER

Client / project
**Canterbury City Council
Connected Canterbury**

Drawing title
**St Radigund's Garden
Landscape General Arrangement Plan**

drawing number	revision
CCC-CCL-HTA-SRG-DR-L-1120	A
scale @ A1	originated by
1:100	SHS
	CCC-CCL

HTA Design LLP
www.hta.co.uk

London | Edinburgh | Manchester | Bristol